

Cable Trays - System of Side Height H40

Perforated Cable Trays - Return Flanges

Ağır Hizmet Kablo Kanalı - Перфорированные лотки



Hot-Dip Galvanized

Important!

Joining cable tray sections together only through the use of couplers 2 pcs for 1 Length
To install cable tray - straight use Screw Sets CFS M6 or CFS M8

APK ... H40					1.0mm	
CODE	Width a mm	Length L mm	KG ad/pc	pcs		
APK 405 10 HDG	50	3000	0.92	2		
APK 407 10 HDG	75	3000	1.08	2		
APK 410 10 HDG	100	3000	1.24	2		
APK 412 10 HDG	125	3000	1.40	2		
APK 415 10 HDG	150	3000	1.56	2		
APK 420 10 HDG	200	3000	1.87	2		
					1.5mm	
APK 405 15 HDG	50	3000	1.36	2		
APK 407 15 HDG	75	3000	1.60	2		
APK 410 15 HDG	100	3000	1.84	2		
APK 412 15 HDG	125	3000	2.07	2		
APK 415 15 HDG	150	3000	2.31	2		
APK 420 15 HDG	200	3000	2.78	2		
APK 422 15 HDG	225	3000	3.01	2		
APK 425 15 HDG	250	3000	3.25	2		
APK 430 15 HDG	300	3000	3.72	2		
APK 440 15 HDG	400	3000	4.66	2		
APK 445 15 HDG	450	3000	5.13	2		
APK 450 15 HDG	500	3000	5.60	2		
APK 460 15 HDG	600	3000	6.55	2		
APK 470 15 HDG	700	3000	7.48	2		
APK 475 15 HDG	750	3000	7.96	2		
APK 480 15 HDG	800	3000	8.43	2		
APK 490 15 HDG	900	3000	9.37	2		
APK 400 15 HDG	1000	3000	10.32	2		

APK ... H40					1.2mm	
CODE	Width a mm	Length L mm	KG ad/pc	pcs		
APK 405 12 HDG	50	3000	1.11	2		
APK 407 12 HDG	75	3000	1.30	2		
APK 410 12 HDG	100	3000	1.48	2		
APK 412 12 HDG	125	3000	1.68	2		
APK 415 12 HDG	150	3000	1.86	2		
APK 420 12 HDG	200	3000	2.24	2		
APK 422 12 HDG	225	3000	2.43	2		
APK 425 12 HDG	250	3000	2.61	2		
APK 430 12 HDG	300	3000	3.00	2		
					2.0mm	
APK 405 20 HDG	50	3000	1.79	2		
APK 407 20 HDG	75	3000	2.11	2		
APK 410 20 HDG	100	3000	2.42	2		
APK 412 20 HDG	125	3000	2.73	2		
APK 415 20 HDG	150	3000	3.04	2		
APK 420 20 HDG	200	3000	3.68	2		
APK 422 20 HDG	225	3000	3.99	2		
APK 425 20 HDG	250	3000	4.30	2		
APK 430 20 HDG	300	3000	4.93	2		
APK 440 20 HDG	400	3000	6.19	2		
APK 445 20 HDG	450	3000	6.81	2		
APK 450 20 HDG	500	3000	7.44	2		
APK 460 20 HDG	600	3000	8.70	2		
APK 470 20 HDG	700	3000	9.96	2		
APK 475 20 HDG	750	3000	10.58	2		
APK 480 20 HDG	800	3000	11.21	2		
APK 490 20 HDG	900	3000	12.47	2		
APK 400 20 HDG	1000	3000	13.72	2		

Straight Connector (Coupler)

Birleştirme Elemanı - Прямой соединитель



To install one lenght ;use 2 pieces of KBE connector
8 sets of CFS bolts and nuts. (M6 or M8)

KBE 2 ... H40					1.2mm	
CODE	Length L mm	KG ad/pc	pcs			
KBE 240 12 HDG	175	0.08	100			
					1.5mm	
KBE 240 15 HDG	175	0.1	100			
					2.0mm	
KBE 240 20 HDG	175	0.13	100			

KBE 3 ... H40					1.2mm	
CODE	Length L mm	KG ad/pc	pcs			
KBE 340 12 HDG	175	0.09	100			
					1.5mm	
KBE 340 15 HDG	175	0.12	100			
					2.0mm	
KBE 340 20 HDG	175	0.15	100			

Electro - Galvanized

CFS M6					M6	
CODE	Size mm	Length L mm	KG Pack	pcs		
CFS M6 EG	M6	15	0.08	500		

CFS M8					M8	
CODE	Size mm	Length L mm	KG Pack	pcs		
CFS M8 EG	M8	15	0.014	500		

APK H40 HDG

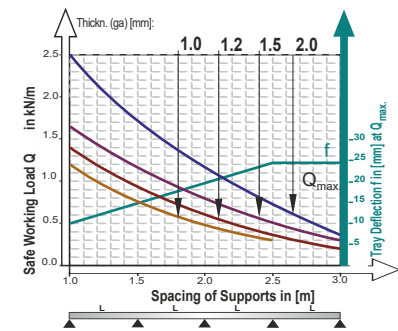
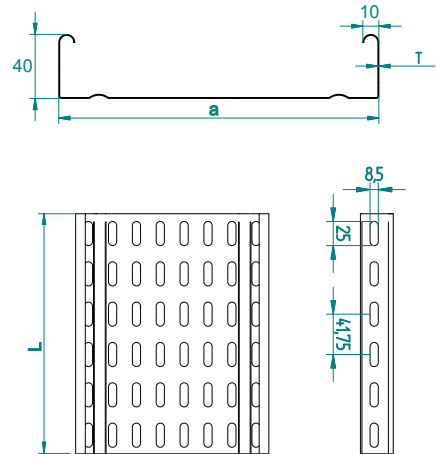

This diagram comply with IEC 61537 with connection to 1/5 of the span and the end span =0,8x the span
Q = max. admissible load (kg/m)
L = support distance (m)
f = Deflection (mm) / Max. deflection = L/100
Safely co-efficient = 1.5

Width	Usable Cross-Section
50	18 cm ²
100	38 cm ²
150	58 cm ²
200	78 cm ²
300	118 cm ²
400	158 cm ²
500	198 cm ²
600	238 cm ²



KBE 2 HDG

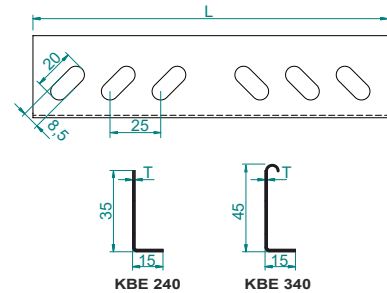

M6x15 Round head squire neck bolt & M6 Flanged nut



APPLICATIONS

Cable routing / Standard : IEC 61537

MATERIAL

Steel, hot-dip galv. to TS-EN ISO 1461:2011 (HDG)

Available finishes:

PG- Steel, strip-galv. acc. to the Sendzimir method to TS-EN 10346:2011 (PG)

SS- stainless steel AISI 304L and AISI 316L (SS)

EP- powder coating in a full range of colours (RAL)

Thickn. (ga) [mm]: 1.0 1.2 1.5 2.0

Cable Trays - System of Side Height H40

Non Perforated Cable Trays - Return Flanges

Ağır Hizmet Deliksiz Kablo Kanalı - Сплошные лотки



Hot-Dip Galvanized

Important!

Joining cable tray sections together only through the use of couplers 2 pcs for 1 Length
To install cable tray - straight use Screw Sets CFS M6 or CFS M8

ADK ... H40					1.0mm
CODE	Width a mm	Length L mm	Kg 1m	pcs	
ADK 405 10 HDG	50	3000	1.15	2	
ADK 407 10 HDG	75	3000	1.35	2	
ADK 410 10 HDG	100	3000	1.54	2	
ADK 412 10 HDG	125	3000	1.74	2	
ADK 415 10 HDG	150	3000	1.94	2	
ADK 420 10 HDG	200	3000	2.33	2	
ADK ... H40					1.5mm
ADK 405 15 HDG	50	3000	1.70	2	
ADK 407 15 HDG	75	3000	1.99	2	
ADK 410 15 HDG	100	3000	2.29	2	
ADK 412 15 HDG	125	3000	2.58	2	
ADK 415 15 HDG	150	3000	2.88	2	
ADK 420 15 HDG	200	3000	3.47	2	
ADK 422 15 HDG	225	3000	3.76	2	
ADK 425 15 HDG	250	3000	4.06	2	
ADK 430 15 HDG	300	3000	4.64	2	
ADK 440 15 HDG	400	3000	5.82	2	
ADK 445 15 HDG	450	3000	6.41	2	
ADK 450 15 HDG	500	3000	7.00	2	
ADK 460 15 HDG	600	3000	8.18	2	
ADK 470 15 HDG	700	3000	9.35	2	
ADK 475 15 HDG	750	3000	9.94	2	
ADK 480 15 HDG	800	3000	10.53	2	
ADK 490 15 HDG	900	3000	11.71	2	
ADK 400 15 HDG	1000	3000	12.89	2	

ADK ... H40					1.2mm
CODE	Width a mm	Length L mm	Kg 1m	pcs	
ADK 405 12 HDG	50	3000	1.38	2	
ADK 407 12 HDG	75	3000	1.62	2	
ADK 410 12 HDG	100	3000	1.85	2	
ADK 412 12 HDG	125	3000	2.09	2	
ADK 415 12 HDG	150	3000	2.32	2	
ADK 420 12 HDG	200	3000	2.79	2	
ADK 422 12 HDG	225	3000	3.03	2	
ADK 425 12 HDG	250	3000	3.26	2	
ADK 430 12 HDG	300	3000	3.74	2	
ADK ... H40					2.0mm
ADK 405 20 HDG	50	3000	2.23	2	
ADK 407 20 HDG	75	3000	2.63	2	
ADK 410 20 HDG	100	3000	3.02	2	
ADK 412 20 HDG	125	3000	3.41	2	
ADK 415 20 HDG	150	3000	3.80	2	
ADK 420 20 HDG	200	3000	4.59	2	
ADK 422 20 HDG	225	3000	4.98	2	
ADK 425 20 HDG	250	3000	5.37	2	
ADK 430 20 HDG	300	3000	6.16	2	
ADK 440 20 HDG	400	3000	7.73	2	
ADK 445 20 HDG	450	3000	8.51	2	
ADK 450 20 HDG	500	3000	9.30	2	
ADK 460 20 HDG	600	3000	10.87	2	
ADK 470 20 HDG	700	3000	12.44	2	
ADK 475 20 HDG	750	3000	13.22	2	
ADK 480 20 HDG	800	3000	14.01	2	
ADK 490 20 HDG	900	3000	15.58	2	
ADK 400 20 HDG	1000	3000	17.15	2	

Adjustable horizontal connector

Yatay seviye değiştirme eki - Угловой соединитель



BYD 240



BYD 340

Important!

To install cable tray - bend use Screw Sets CFS M6 or CFS M8

Hot-Dip Galvanized

BYD 2 ... H40					1.2mm
CODE	Length L mm	Kg ad/pc	pcs		
BYD 240 12 HDG	175	0.08	100		
BYD 2 ... H40					1.5mm
BYD 240 15 HDG	175	0.1	100		
BYD 2 ... H40					2.0mm
BYD 240 20 HDG	175	0.13	100		

BYD 3 ... H40					1.2mm
CODE	Length L mm	Kg ad/pc	pcs		
BYD 340 12 HDG	175	0.09	100		
BYD 3 ... H40					1.5mm
BYD 340 15 HDG	175	0.12	100		
BYD 3 ... H40					2.0mm
BYD 340 20 HDG	175	0.15	100		

ADK H40 HDG

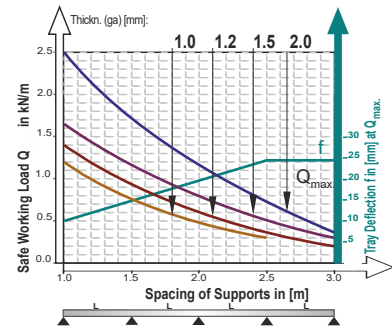
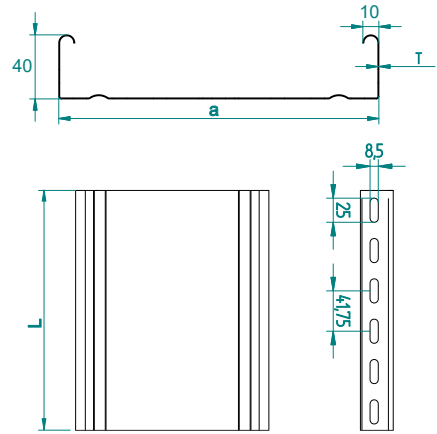

This diagram comply with IEC 61537 with connection to 1/5 of the span and the end span = 0,8x the span
Q = max. admissible load (kg/m)
L = support distance (m)
f = Deflection (mm) / Max. deflection = L/100
Safety co-efficient = 1.5



Width	Usable Cross-Section
50	18 cm ²
100	38 cm ²
150	58 cm ²
200	78 cm ²
300	118 cm ²
400	158 cm ²
500	198 cm ²
600	238 cm ²

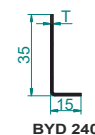
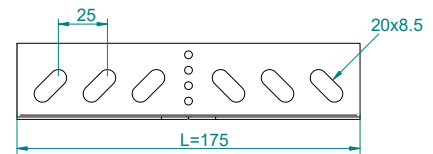

BYD 240

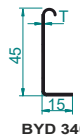

BYD 340

APPLICATIONS

Cable routing / Standard : IEC 61537

MATERIAL

Steel, hot-dip galv. to TS-EN ISO 1461:2011 (HDG)

Available finishes:

PG- Steel, strip-galv. acc. to the Sendzimir method to TS-EN 10346:2011 (PG)

SS- stainless steel AISI 304L and AISI 316L (SS)

EP- powder coating in a full range of colours (RAL)

Thickn. (ga) [mm]: 1.0 1.2 1.5 2.0

Cable Trays - System of Side Height H40

90° Horizontal Bend of Cable Tray

90° Yatay Kanal Dönüş Elemanı - Угол горизонтальный 90°



Important!
To install cable tray - bend use Screw Sets
CFS M6 or CFS M8

Pre - Galvanized

KA90 ... H40		1.0mm	
CODE	Width a=b mm	Kg ad/pc	pcs
KA90 405 10 HDG	50	0.23	1
KA90 407 10 HDG	75	0.30	1
KA90 410 10 HDG	100	0.45	1
KA90 412 10 HDG	125	0.53	1
KA90 415 10 HDG	150	0.63	1
KA90 420 10 HDG	200	0.84	1
KA90 405 15 HDG	50	0.35	1
KA90 407 15 HDG	75	0.44	1
KA90 410 15 HDG	100	0.67	1
KA90 412 15 HDG	125	0.80	1
KA90 415 15 HDG	150	0.94	1
KA90 420 15 HDG	200	1.26	1
KA90 422 15 HDG	225	1.44	1
KA90 425 15 HDG	250	1.63	1
KA90 430 15 HDG	300	2.18	1
KA90 440 15 HDG	400	3.17	1
KA90 445 15 HDG	450	3.74	1
KA90 450 15 HDG	500	4.36	1
KA90 460 15 HDG	600	5.74	1
KA90 470 15 HDG	700	7.30	1
KA90 475 15 HDG	750	8.15	1
KA90 480 15 HDG	800	9.05	1
KA90 490 15 HDG	900	10.99	1
KA90 400 15 HDG	1000	13.12	1

KA90 ... H40		1.2mm	
CODE	Width a=b mm	Kg ad/pc	pcs
KA90 405 12 HDG	50	0.28	1
KA90 407 12 HDG	75	0.35	1
KA90 410 12 HDG	100	0.53	1
KA90 412 12 HDG	125	0.64	1
KA90 415 12 HDG	150	0.75	1
KA90 420 12 HDG	200	1.01	1
KA90 422 12 HDG	225	1.15	1
KA90 425 12 HDG	250	1.30	1
KA90 430 12 HDG	300	1.74	1
KA90 405 20 HDG	50	0.46	1
KA90 407 20 HDG	75	0.59	1
KA90 410 20 HDG	100	0.89	1
KA90 412 20 HDG	125	1.06	1
KA90 415 20 HDG	150	1.25	1
KA90 420 20 HDG	200	1.68	1
KA90 422 20 HDG	225	1.92	1
KA90 425 20 HDG	250	2.17	1
KA90 430 20 HDG	300	2.90	1
KA90 440 20 HDG	400	4.23	1
KA90 445 20 HDG	450	4.99	1
KA90 450 20 HDG	500	5.81	1
KA90 460 20 HDG	600	7.65	1
KA90 470 20 HDG	700	9.73	1
KA90 475 20 HDG	750	10.87	1
KA90 480 20 HDG	800	12.07	1
KA90 490 20 HDG	900	14.65	1
KA90 400 20 HDG	1000	17.49	1

90° Horizontal Bend of Cable Tray Radius:150

90° Yatay Kanal Dönüş Elemanı Radyus:150 - Угол горизонтальный 90° Радиус:150



Important!
To install cable tray - bend use Screw Sets
CFS M6 or CFS M8

Hot-Dip Galvanized

KA90R1 ... H40		1.5mm	
CODE	Width a=b mm	Kg ad/pc	pcs
KA90R1 405 15 HDG	50	0.37	1
KA90R1 407 15 HDG	75	0.50	1
KA90R1 410 15 HDG	100	0.64	1
KA90R1 412 15 HDG	125	0.79	1
KA90R1 415 15 HDG	150	0.97	1
KA90R1 420 15 HDG	200	1.37	1
KA90R1 422 15 HDG	225	1.60	1
KA90R1 425 15 HDG	250	1.85	1
KA90R1 430 15 HDG	300	2.40	1
KA90R1 440 15 HDG	400	3.70	1
KA90R1 445 15 HDG	450	4.23	1
KA90R1 450 15 HDG	500	5.00	1
KA90R1 460 15 HDG	600	6.36	1
KA90R1 470 15 HDG	700	7.99	1
KA90R1 475 15 HDG	750	8.99	1
KA90R1 480 15 HDG	800	9.70	1
KA90R1 490 15 HDG	900	11.91	1
KA90R1 400 15 HDG	1000	14.35	1

KA90R1 ... H50		2.0mm	
CODE	Width a=b mm	Kg ad/pc	pcs
KA90R1 405 20 HDG	50	0.49	1
KA90R1 407 20 HDG	75	0.66	1
KA90R1 410 20 HDG	100	0.85	1
KA90R1 412 20 HDG	125	1.06	1
KA90R1 415 20 HDG	150	1.29	1
KA90R1 420 20 HDG	200	1.83	1
KA90R1 422 20 HDG	225	2.14	1
KA90R1 425 20 HDG	250	2.47	1
KA90R1 430 20 HDG	300	3.19	1
KA90R1 440 20 HDG	400	4.93	1
KA90R1 445 20 HDG	450	5.63	1
KA90R1 450 20 HDG	500	6.67	1
KA90R1 460 20 HDG	600	8.48	1
KA90R1 470 20 HDG	700	10.65	1
KA90R1 475 20 HDG	750	11.98	1
KA90R1 480 20 HDG	800	12.94	1
KA90R1 490 20 HDG	900	15.88	1
KA90R1 400 20 HDG	1000	19.13	1

KA90 H40

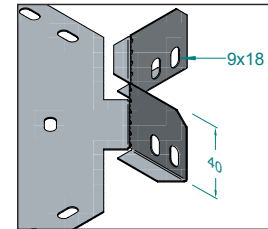
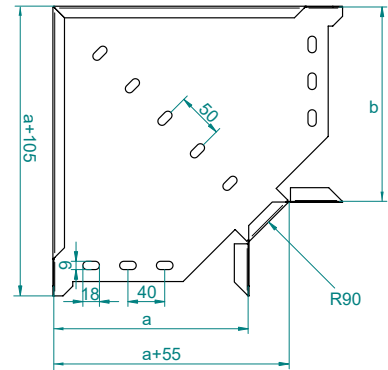

KA90R1 H40

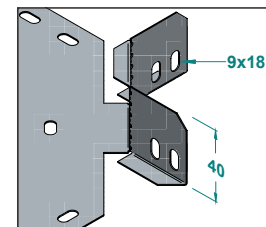
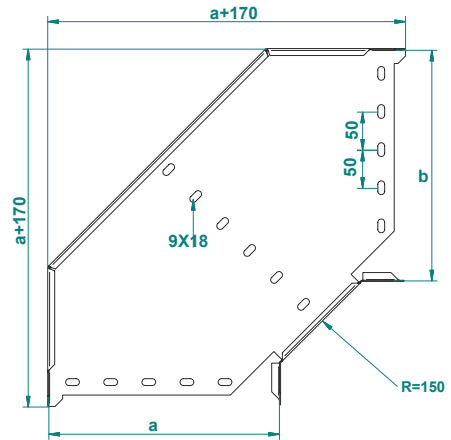

APPLICATIONS

Cable routing / Standard : IEC 61537

MATERIAL

Steel, hot-dip galv. to TS-EN ISO 1461:2011 (HDG)

Available finishes:

PG- Steel, strip-galv. acc. to the Sendzimir method to TS-EN 10346:2011 (PG)

SS- stainless steel AISI 304L and AISI 316L (SS)

EP- powder coating in a full range of colours (RAL)

Thickn. (ga) [mm]: 1.0 1.2 1.5 2.0

Cable Trays - System of Side Height H40

90° Horizontal Bend of Cable Tray Radius:300

90° Yatay Kanal Dönüş Elemanı Radyus:300 - Угол горизонтальный 90° Радиус:300



Important!

To install bend - use 2 pieces of KBE con. and 8 sets of CFS bolts and nuts (M6 or M8).

Hot-Dip Galvanized

KA90R2 ... H40		1.5mm	
CODE	Width a=b	kg ad/pc	pcs
KA90R2 405 15 HDG	50	1,29	1
KA90R2 407 15 HDG	75	1,88	1
KA90R2 410 15 HDG	100	2,17	1
KA90R2 412 15 HDG	125	2,46	1
KA90R2 415 15 HDG	150	2,77	1
KA90R2 420 15 HDG	200	3,41	1
KA90R2 422 15 HDG	225	3,75	1
KA90R2 425 15 HDG	250	4,11	1
KA90R2 430 15 HDG	300	4,84	1
KA90R2 440 15 HDG	400	6,46	1
KA90R2 445 15 HDG	450	7,34	1
KA90R2 450 15 HDG	500	8,26	1
KA90R2 460 15 HDG	600	10,25	1
KA90R2 470 15 HDG	700	12,42	1
KA90R2 475 15 HDG	750	13,57	1
KA90R2 480 15 HDG	800	14,77	1
KA90R2 490 15 HDG	900	17,32	1
KA90R2 400 15 HDG	1000	20,05	1

KA90R2 ... H40		2.0mm	
CODE	Width a=b mm	kg ad/pc	pcs
KA90R2 405 20 HDG	50	2,15	1
KA90R2 407 20 HDG	75	2,51	1
KA90R2 410 20 HDG	100	2,89	1
KA90R2 412 20 HDG	125	3,28	1
KA90R2 415 20 HDG	150	3,69	1
KA90R2 420 20 HDG	200	4,55	1
KA90R2 422 20 HDG	225	5,01	1
KA90R2 425 20 HDG	250	5,48	1
KA90R2 430 20 HDG	300	6,46	1
KA90R2 440 20 HDG	400	8,61	1
KA90R2 445 20 HDG	450	9,78	1
KA90R2 450 20 HDG	500	11,02	1
KA90R2 460 20 HDG	600	13,66	1
KA90R2 470 20 HDG	700	16,56	1
KA90R2 475 20 HDG	750	18,10	1
KA90R2 480 20 HDG	800	19,70	1
KA90R2 490 20 HDG	900	23,09	1
KA90R2 400 20 HDG	1000	26,72	1

KA90 R2 H40 HDG

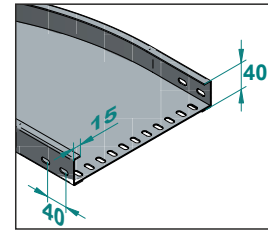
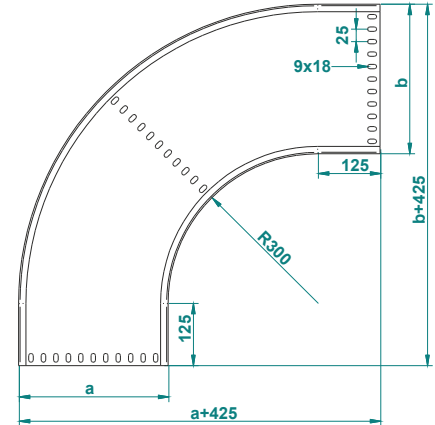

KA90 R4 H40 HDG

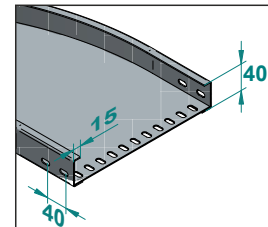
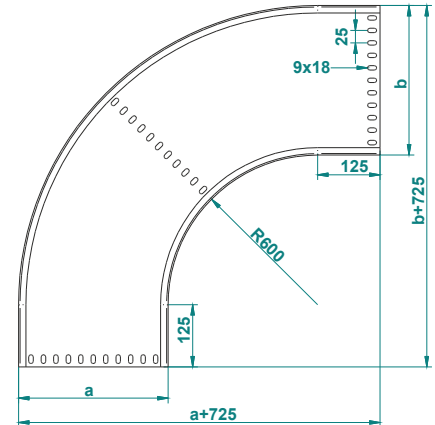

90° Horizontal Bend of Cable Tray Radius:600

90° Yatay Kanal Dönüş Elemanı Radyus:600 - Угол горизонтальный 90° Радиус:600



Important!

To install bend - use 2 pieces of KBE con. and 8 sets of CFS bolts and nuts (M6 or M8).

Hot-Dip Galvanized

KA90R4 ... H40		1.5mm	
CODE	Width a=b mm	kg ad/pc	pcs
KA90R4 405 15 HDG	50	2,61	1
KA90R4 407 15 HDG	75	3,02	1
KA90R4 410 15 HDG	100	3,44	1
KA90R4 412 15 HDG	125	3,87	1
KA90R4 415 15 HDG	150	4,32	1
KA90R4 420 15 HDG	200	5,24	1
KA90R4 422 15 HDG	225	5,73	1
KA90R4 425 15 HDG	250	6,22	1
KA90R4 430 15 HDG	300	7,24	1
KA90R4 440 15 HDG	400	9,41	1
KA90R4 445 15 HDG	450	10,56	1
KA90R4 450 15 HDG	500	11,76	1
KA90R4 460 15 HDG	600	14,30	1
KA90R4 470 15 HDG	700	17,03	1
KA90R4 475 15 HDG	750	18,46	1
KA90R4 480 15 HDG	800	19,94	1
KA90R4 490 15 HDG	900	23,03	1
KA90R4 400 15 HDG	1000	26,31	1

KA90R4 ... H40		2.0mm	
CODE	Width a=b mm	kg ad/pc	pcs
KA90R4 405 20 HDG	50	3,48	1
KA90R4 407 20 HDG	75	4,03	1
KA90R4 410 20 HDG	100	4,59	1
KA90R4 412 20 HDG	125	5,17	1
KA90R4 415 20 HDG	150	5,76	1
KA90R4 420 20 HDG	200	6,99	1
KA90R4 422 20 HDG	225	7,63	1
KA90R4 425 20 HDG	250	8,28	1
KA90R4 430 20 HDG	300	9,64	1
KA90R4 440 20 HDG	400	12,53	1
KA90R4 445 20 HDG	450	14,07	1
KA90R4 450 20 HDG	500	15,67	1
KA90R4 460 20 HDG	600	19,06	1
KA90R4 470 20 HDG	700	22,69	1
KA90R4 475 20 HDG	750	24,60	1
KA90R4 480 20 HDG	800	26,57	1
KA90R4 490 20 HDG	900	30,07	1
KA90R4 400 20 HDG	1000	35,08	1

APPLICATIONS

Cable routing

MATERIAL

HDG-steel, hot-dip galv. to TS-EN ISO 1461:2011 (HDG)

Available finishes:

Steel, strip-galv. acc. to the Sendzimir method to TS-EN 10346:2011 (PG)
 SS- stainless steel AISI 304L and AISI 316L (SS)
 EP- powder coating in a full range of colours (RAL)

Thickn. (ga) [mm]: **1.5 2.0**

Cable Trays - System of Side Height H40

45° Horizontal Bend of Cable Tray

45° Yatay Kanal Dönüş Elemanı - Угол горизонтальный 45°



Important!

To install bend - use 2 pieces of KBE con. and 8 sets of CFS bolts and nuts (M6 or M8).

KA45 H40 HDG

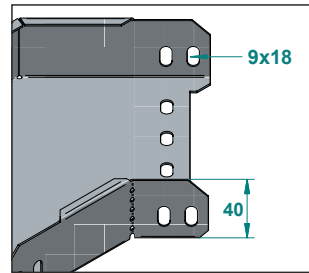
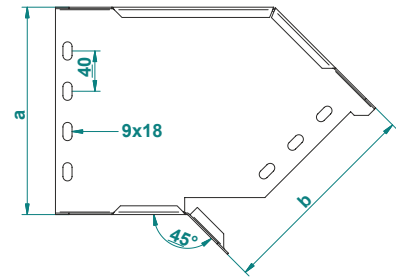

Hot-Dip Galvanized

KA45 ... H40		1.0mm	
CODE	Width a=b	kg ad/pc	pcs
KA45 405 10 HDG	50	0,22	1
KA45 407 10 HDG	75	0,28	1
KA45 410 10 HDG	100	0,34	1
KA45 412 10 HDG	125	0,40	1
KA45 415 10 HDG	150	0,47	1
KA45 420 10 HDG	200	0,61	1
KA45 ... H40		1.5mm	
KA45 405 15 HDG	50	0,33	1
KA45 407 15 HDG	75	0,41	1
KA45 410 15 HDG	100	0,50	1
KA45 412 15 HDG	125	0,59	1
KA45 415 15 HDG	150	0,70	1
KA45 420 15 HDG	200	0,92	1
KA45 422 15 HDG	225	1,21	1
KA45 425 15 HDG	250	1,36	1
KA45 430 15 HDG	300	1,68	1
KA45 440 15 HDG	400	2,40	1
KA45 445 15 HDG	450	2,81	1
KA45 450 15 HDG	500	3,25	1
KA45 460 15 HDG	600	4,21	1
KA45 470 15 HDG	700	5,30	1
KA45 475 15 HDG	750	5,90	1
KA45 480 15 HDG	800	6,52	1
KA45 490 15 HDG	900	7,85	1
KA45 400 15 HDG	1000	9,31	1

KA45 ... H40		1.2mm	
CODE	Width a=b	kg ad/pc	pcs
KA45 405 12 HDG	50	0,27	1
KA45 407 12 HDG	75	0,33	1
KA45 410 12 HDG	100	0,40	1
KA45 412 12 HDG	125	0,48	1
KA45 415 12 HDG	150	0,56	1
KA45 420 12 HDG	200	0,74	1
KA45 422 12 HDG	225	0,97	1
KA45 425 12 HDG	250	1,09	1
KA45 430 12 HDG	300	1,34	1
KA45 ... H40		2.0mm	
KA45 405 20 HDG	50	0,44	1
KA45 407 20 HDG	75	0,55	1
KA45 410 20 HDG	100	0,67	1
KA45 412 20 HDG	125	0,79	1
KA45 415 20 HDG	150	0,93	1
KA45 420 20 HDG	200	1,22	1
KA45 422 20 HDG	225	1,62	1
KA45 425 20 HDG	250	1,81	1
KA45 430 20 HDG	300	2,23	1
KA45 440 20 HDG	400	3,20	1
KA45 445 20 HDG	450	3,74	1
KA45 450 20 HDG	500	4,33	1
KA45 460 20 HDG	600	5,62	1
KA45 470 20 HDG	700	7,07	1
KA45 475 20 HDG	750	7,86	1
KA45 480 20 HDG	800	8,69	1
KA45 490 20 HDG	900	10,47	1
KA45 400 20 HDG	1000	12,42	1

Horizontal Adjustable Bends 15-90°

15-90° Yatay Hareketli Dönüş Elemanı- Шарнирный горизонтальный угол 15-90°



Important!

To install bend - use 2 pieces of KBE con. and 8 sets of CFS bolts and nuts (M6 or M8).

KA90H H40 HDG

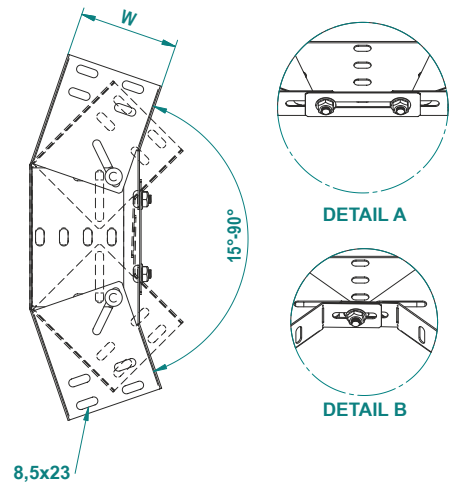

Hot-Dip Galvanized

KA90H ... H40		1.5mm	
CODE	Width W	kg ad/pc	pcs
KA90H 405 15 HDG	50	0,49	1
KA90H 407 15 HDG	75	0,59	1
KA90H 410 15 HDG	100	0,68	1
KA90H 412 15 HDG	125	0,97	1
KA90H 415 15 HDG	150	1,20	1
KA90H 420 15 HDG	200	1,81	1
KA90H 422 15 HDG	225	2,16	1
KA90H 425 15 HDG	250	2,65	1
KA90H 430 15 HDG	300	3,51	1

KA90H ... H40		2.0mm	
CODE	Width W	kg ad/pc	pcs
KA90H 405 20 HDG	50	0,66	1
KA90H 407 20 HDG	75	0,78	1
KA90H 410 20 HDG	100	0,91	1
KA90H 412 20 HDG	125	1,29	1
KA90H 415 20 HDG	150	1,59	1
KA90H 420 20 HDG	200	2,41	1
KA90H 422 20 HDG	225	2,88	1
KA90H 425 20 HDG	250	3,53	1
KA90H 430 20 HDG	300	4,68	1

APPLICATIONS

Cable routing

MATERIAL

HDG-steel, hot-dip galv. to TS-EN ISO 1461:2011 (HDG)

Available finishes:

Steel, strip-galv. acc. to the Sendzimir method to TS-EN 10346:2011 (PG)
SS- stainless steel AISI 304L and AISI 316L (SS)
EP- powder coating in a full range of colours (RAL)

Thickn. (ga) [mm]: **1.0 1.2 1.5 2.0**

Cable Trays - System of Side Height H40

45° Horizontal Bend of Cable Tray Radius:300

45° Yatay Kanal Dönüş Elemanı Radyus:300 - Угол горизонтальный 45° Радиус:300



Important!

To install bend - use 2 pieces of KBE con. and 8 sets of CFS bolts and nuts (M6 or M8).

Hot-Dip Galvanized

KA45R2 ... H40		1.5mm	
CODE	Width a=b mm	kg ad/pce.	pcs
KA45R2 405 15 HDG	50	1,07	1
KA45R2 407 15 HDG	75	1,25	1
KA45R2 410 15 HDG	100	1,42	1
KA45R2 412 15 HDG	125	1,61	1
KA45R2 415 15 HDG	150	1,80	1
KA45R2 420 15 HDG	200	2,19	1
KA45R2 422 15 HDG	225	2,41	1
KA45R2 425 15 HDG	250	2,61	1
KA45R2 430 15 HDG	300	3,06	1
KA45R2 440 15 HDG	400	4,01	1
KA45R2 445 15 HDG	450	4,52	1
KA45R2 450 15 HDG	500	5,06	1
KA45R2 460 15 HDG	600	6,20	1
KA45R2 470 15 HDG	700	7,43	1
KA45R2 475 15 HDG	750	8,08	1
KA45R2 480 15 HDG	800	8,76	1
KA45R2 490 15 HDG	900	10,17	1
KA45R2 400 15 HDG	1000	11,68	1

KA45R2 ... H40		2.0mm	
CODE	Width a=b mm	kg ad/pce.	pcs
KA45R2 405 20 HDG	50	1,43	1
KA45R2 407 20 HDG	75	1,66	1
KA45R2 410 20 HDG	100	1,90	1
KA45R2 412 20 HDG	125	2,14	1
KA45R2 415 20 HDG	150	2,40	1
KA45R2 420 20 HDG	200	2,93	1
KA45R2 422 20 HDG	225	3,20	1
KA45R2 425 20 HDG	250	3,49	1
KA45R2 430 20 HDG	300	4,08	1
KA45R2 440 20 HDG	400	5,35	1
KA45R2 445 20 HDG	450	6,03	1
KA45R2 450 20 HDG	500	6,75	1
KA45R2 460 20 HDG	600	8,27	1
KA45R2 470 20 HDG	700	9,91	1
KA45R2 475 20 HDG	750	10,78	1
KA45R2 480 20 HDG	800	11,68	1
KA45R2 490 20 HDG	900	13,57	1
KA45R2 400 20 HDG	1000	15,58	1

KA45R2 H40 HDG

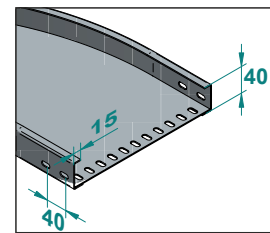
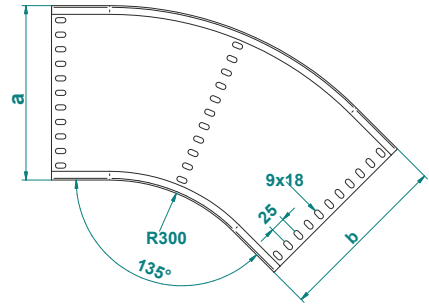

KA45R4 H40 HDG

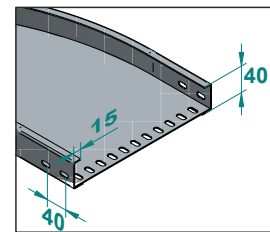
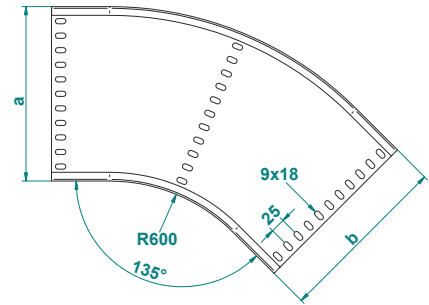

45° Horizontal Bend of Cable Tray Radius:600

45° Yatay Kanal Dönüş Elemanı Radyus:600 - Угол горизонтальный 45° Радиус:600



Important!

To install bend - use 2 pieces of KBE con. and 8 sets of CFS bolts and nuts (M6 or M8).

Hot-Dip Galvanized

KA45R4 ... H40		1.5mm	
CODE	Width a=b mm	kg ad/pce.	pcs
KA45R4 405 15 HDG	50	1,57	1
KA45R4 407 15 HDG	75	1,82	1
KA45R4 410 15 HDG	100	2,06	1
KA45R4 412 15 HDG	125	2,32	1
KA45R4 415 15 HDG	150	2,57	1
KA45R4 420 15 HDG	200	3,11	1
KA45R4 422 15 HDG	225	3,39	1
KA45R4 425 15 HDG	250	3,67	1
KA45R4 430 15 HDG	300	4,25	1
KA45R4 440 15 HDG	400	5,48	1
KA45R4 445 15 HDG	450	6,13	1
KA45R4 450 15 HDG	500	6,81	1
KA45R4 460 15 HDG	600	8,22	1
KA45R4 470 15 HDG	700	9,73	1
KA45R4 475 15 HDG	750	10,52	1
KA45R4 480 15 HDG	800	11,33	1
KA45R4 490 15 HDG	900	13,03	1
KA45R4 400 15 HDG	1000	14,82	1

KA45R4 ... H40		2.0mm	
CODE	Width a=b mm	kg ad/pce.	pcs
KA45R4 405 20 HDG	50	2,10	1
KA45R4 407 20 HDG	75	2,42	1
KA45R4 410 20 HDG	100	2,75	1
KA45R4 412 20 HDG	125	3,09	1
KA45R4 415 20 HDG	150	3,43	1
KA45R4 420 20 HDG	200	4,15	1
KA45R4 422 20 HDG	225	4,51	1
KA45R4 425 20 HDG	250	4,89	1
KA45R4 430 20 HDG	300	5,67	1
KA45R4 440 20 HDG	400	7,31	1
KA45R4 445 20 HDG	450	8,18	1
KA45R4 450 20 HDG	500	9,08	1
KA45R4 460 20 HDG	600	10,97	1
KA45R4 470 20 HDG	700	12,98	1
KA45R4 475 20 HDG	750	14,03	1
KA45R4 480 20 HDG	800	15,11	1
KA45R4 490 20 HDG	900	17,37	1
KA45R4 400 20 HDG	1000	19,76	1

APPLICATIONS

Cable routing

MATERIAL

HDG-steel, hot-dip galv. to TS-EN ISO 1461:2011 (HDG)

Available finishes:

Steel, strip-galv. acc. to the Sendzimir method to TS-EN 10346:2011 (PG)
SS- stainless steel AISI 304L and AISI 316L (SS)
EP- powder coating in a full range of colours (RAL)

Thickn. (ga) [mm]: 1.5 2.0

Cable Trays - System of Side Height H40

Tee Horizontal Bend of Cable Tray

"T" Yatay Kanal Dönüş Elemanı - T-отвод горизонтальный



Important!

To install cable tray - bend use Screw Sets CFS M6 or CFS M8

Hot-Dip Galvanized

KAT ... H40		1.0mm	
CODE	Width a=b=c mm	KG ad/pc	pcs
KAT 405 10 HDG	50	0.29	1
KAT 407 10 HDG	75	0.36	1
KAT 410 10 HDG	100	0.55	1
KAT 412 10 HDG	125	0.64	1
KAT 415 10 HDG	150	0.75	1
KAT 420 10 HDG	200	0.98	1
KAT ... H40		1.5mm	
CODE	Width a=b=c mm	KG ad/pc	pcs
KAT 405 15 HDG	50	0.43	1
KAT 407 15 HDG	75	0.53	1
KAT 410 15 HDG	100	0.82	1
KAT 412 15 HDG	125	0.96	1
KAT 415 15 HDG	150	1.12	1
KAT 420 15 HDG	200	1.47	1
KAT 422 15 HDG	225	1.66	1
KAT 425 15 HDG	250	1.86	1
KAT 430 15 HDG	300	2.56	1
KAT 440 15 HDG	400	3.64	1
KAT 445 15 HDG	450	4.25	1
KAT 450 15 HDG	500	4.91	1
KAT 460 15 HDG	600	6.36	1
KAT 470 15 HDG	700	8.00	1
KAT 475 15 HDG	750	8.90	1
KAT 480 15 HDG	800	9.84	1
KAT 490 15 HDG	900	11.86	1
KAT 400 15 HDG	1000	14.07	1

KAT ... H40		1.2mm	
CODE	Width a=b=c mm	KG ad/pc	pcs
KAT 405 12 HDG	50	0.34	1
KAT 407 12 HDG	75	0.43	1
KAT 410 12 HDG	100	0.65	1
KAT 412 12 HDG	125	0.77	1
KAT 415 12 HDG	150	0.90	1
KAT 420 12 HDG	200	1.17	1
KAT 422 12 HDG	225	1.33	1
KAT 425 12 HDG	250	1.49	1
KAT 430 12 HDG	300	2.05	1
KAT ... H40		2.0mm	
CODE	Width a=b=c mm	KG ad/pc	pcs
KAT 405 20 HDG	50	0.57	1
KAT 407 20 HDG	75	0.71	1
KAT 410 20 HDG	100	1.09	1
KAT 412 20 HDG	125	1.28	1
KAT 415 20 HDG	150	1.49	1
KAT 420 20 HDG	200	1.95	1
KAT 422 20 HDG	225	2.21	1
KAT 425 20 HDG	250	2.48	1
KAT 430 20 HDG	300	3.41	1
KAT 440 20 HDG	400	4.85	1
KAT 445 20 HDG	450	5.66	1
KAT 450 20 HDG	500	6.54	1
KAT 460 20 HDG	600	8.48	1
KAT 470 20 HDG	700	10.67	1
KAT 475 20 HDG	750	11.86	1
KAT 480 20 HDG	800	13.11	1
KAT 490 20 HDG	900	15.81	1
KAT 400 20 HDG	1000	18.75	1

KAT H40 HDG

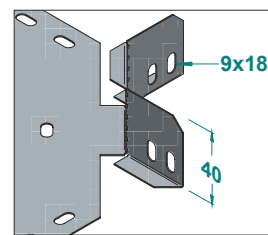
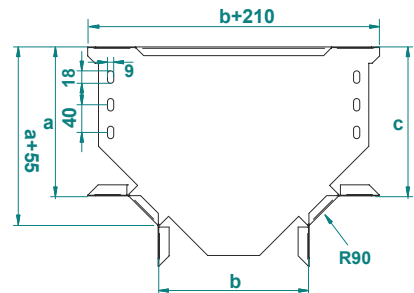

KATR1 H40 HDG

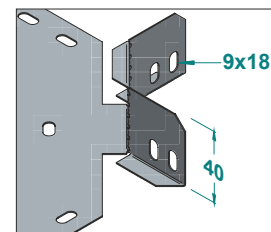
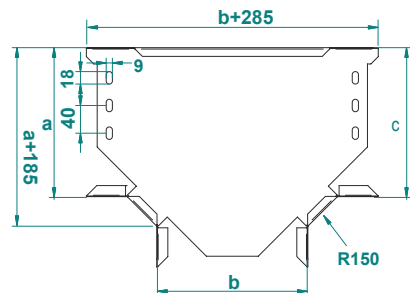

Tee Horizontal Bend of Cable Tray Radius:150

"T" Yatay Kanal Dönüş Elemanı Radius:150 - T-отвод горизонтальный Радиус:150



Important!

To install cable tray - bend use Screw Sets CFS M6 or CFS M8

Hot-Dip Galvanized

KATR1 ... H40		1.5mm	
CODE	Width a=b=c mm	KG ad/pc	pcs
KATR1 405 15 HDG	50	1.33	1
KATR1 407 15 HDG	75	1.52	1
KATR1 410 15 HDG	100	1.72	1
KATR1 412 15 HDG	125	1.93	1
KATR1 415 15 HDG	150	2.15	1
KATR1 420 15 HDG	200	2.64	1
KATR1 422 15 HDG	225	2.90	1
KATR1 425 15 HDG	250	3.17	1
KATR1 430 15 HDG	300	3.74	1
KATR1 440 15 HDG	400	5.04	1
KATR1 445 15 HDG	450	5.76	1
KATR1 450 15 HDG	500	6.52	1
KATR1 460 15 HDG	600	8.19	1
KATR1 470 15 HDG	700	10.06	1
KATR1 475 15 HDG	750	11.06	1
KATR1 480 15 HDG	800	12.10	1
KATR1 490 15 HDG	900	14.34	1
KATR1 400 15 HDG	1000	16.77	1

KATR1 ... H40		2.0mm	
CODE	Width a=b=c mm	KG ad/pc	pcs
KATR1 405 20 HDG	50	1.77	1
KATR1 407 20 HDG	75	2.02	1
KATR1 410 20 HDG	100	2.44	1
KATR1 412 20 HDG	125	2.29	1
KATR1 415 20 HDG	150	2.57	1
KATR1 420 20 HDG	200	2.87	1
KATR1 422 20 HDG	225	3.51	1
KATR1 425 20 HDG	250	3.86	1
KATR1 430 20 HDG	300	4.22	1
KATR1 440 20 HDG	400	4.99	1
KATR1 445 20 HDG	450	6.72	1
KATR1 450 20 HDG	500	7.67	1
KATR1 460 20 HDG	600	8.70	1
KATR1 470 20 HDG	700	10.92	1
KATR1 475 20 HDG	750	13.41	1
KATR1 480 20 HDG	800	14.74	1
KATR1 490 20 HDG	900	19.12	1
KATR1 400 20 HDG	1000	22.35	1

APPLICATIONS

Cable routing

MATERIAL

HDG-steel, hot-dip galv. to TS-EN ISO 1461:2011 (HDG)

Available finishes:

Steel, strip-galv. acc. to the Sendzimir method to TS-EN 10346:2011 (PG)
SS- stainless steel AISI 304L and AISI 316L (SS)
EP- powder coating in a full range of colours (RAL)

Thickn. (ga) [mm]: 1.5 2.0

Cable Trays - System of Side Height H40

Tee Horizontal Bend od Cable Tray Radius:300

"T" Yatay Kanal Dönüş Elemanı Radius:300 - T-отвод горизонтальный Радиус:300



Important!

To install bend - use 6 pieces of KBE con. and 24 sets of CFS bolts and nuts (M6 or M8).

Hot-Dip Galvanized

KATR2 ... H40		1.5mm	
CODE	Width a=b=c mm	Kg ad/pc	pcs
KATR2 405 15 HDG	50	3.71	1
KATR2 407 15 HDG	75	4.14	1
KATR2 410 15 HDG	100	4.59	1
KATR2 412 15 HDG	125	5.05	1
KATR2 415 15 HDG	150	5.52	1
KATR2 420 15 HDG	200	6.52	1
KATR2 422 15 HDG	225	7.04	1
KATR2 425 15 HDG	250	7.59	1
KATR2 430 15 HDG	300	8.70	1
KATR2 440 15 HDG	400	11.11	1
KATR2 445 15 HDG	450	12.40	1
KATR2 450 15 HDG	500	13.75	1
KATR2 460 15 HDG	600	16.62	1
KATR2 470 15 HDG	700	19.75	1
KATR2 475 15 HDG	750	21.39	1
KATR2 480 15 HDG	800	23.09	1
KATR2 490 15 HDG	900	26.68	1
KATR2 400 15 HDG	1000	30.05	1

KATR2 ... H40		2.0mm	
CODE	Width a=b=c mm	Kg ad/pc	pcs
KATR2 405 20 HDG	50	4.94	1
KATR2 407 20 HDG	75	5.52	1
KATR2 410 20 HDG	100	6.12	1
KATR2 412 20 HDG	125	6.74	1
KATR2 415 20 HDG	150	7.36	1
KATR2 420 20 HDG	200	8.70	1
KATR2 422 20 HDG	225	9.40	1
KATR2 425 20 HDG	250	10.10	1
KATR2 430 20 HDG	300	11.60	1
KATR2 440 20 HDG	400	14.81	1
KATR2 445 20 HDG	450	16.53	1
KATR2 450 20 HDG	500	18.33	1
KATR2 460 20 HDG	600	22.17	1
KATR2 470 20 HDG	700	26.32	1
KATR2 475 20 HDG	750	28.51	1
KATR2 480 20 HDG	800	30.79	1
KATR2 490 20 HDG	900	35.57	1
KATR2 400 20 HDG	1000	40.67	1

KATR2 H40 HDG

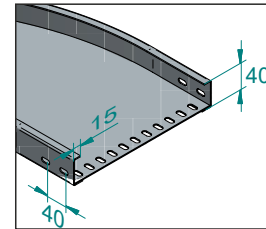
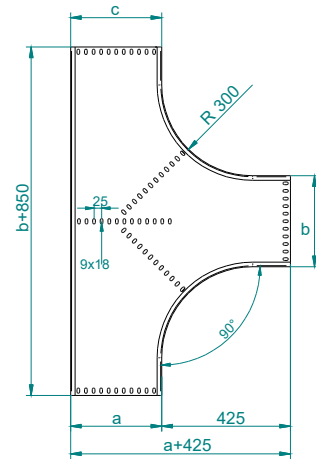

KATR4 H40 HDG

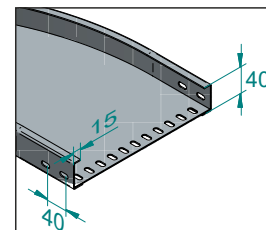
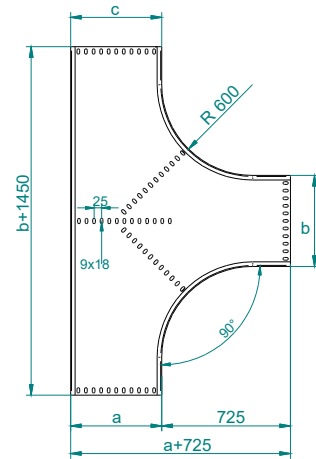

Tee Horizontal Bend od Cable Tray Radius:600

"T" Yatay Kanal Dönüş Elemanı Radius:600 - T-отвод горизонтальный Радиус:600



Important!

To install bend - use 6 pieces of KBE con. and 24 sets of CFS bolts and nuts (M6 or M8).

Hot-Dip Galvanized

KATR4 ... H40		1.5mm	
CODE	Width a=b=c mm	Kg ad/pc.	pcs
KATR4 405 15 HDG	50	7.31	1
KATR4 407 15 HDG	75	8.01	1
KATR4 410 15 HDG	100	8.72	1
KATR4 412 15 HDG	125	9.45	1
KATR4 415 15 HDG	150	10.19	1
KATR4 420 15 HDG	200	11.72	1
KATR4 422 15 HDG	225	12.51	1
KATR4 425 15 HDG	250	13.31	1
KATR4 430 15 HDG	300	14.95	1
KATR4 440 15 HDG	400	18.42	1
KATR4 450 15 HDG	450	20.24	1
KATR4 460 15 HDG	500	22.12	1
KATR4 470 15 HDG	600	26.06	1
KATR4 475 15 HDG	700	30.24	1
KATR4 480 15 HDG	800	34.64	1
KATR4 490 15 HDG	900	39.29	1
KATR4 400 15 HDG	1000	44.17	1

KATR4 ... H40		2.0mm	
CODE	Width a=b=c mm	Kg ad/pc.	pcs
KATR4 405 20 HDG	50	9.75	1
KATR4 407 20 HDG	75	10.68	1
KATR4 410 20 HDG	100	11.62	1
KATR4 412 20 HDG	125	12.60	1
KATR4 415 20 HDG	150	13.59	1
KATR4 420 20 HDG	200	15.62	1
KATR4 422 20 HDG	225	16.67	1
KATR4 425 20 HDG	250	17.74	1
KATR4 430 20 HDG	300	19.93	1
KATR4 440 20 HDG	400	24.55	1
KATR4 450 20 HDG	450	26.99	1
KATR4 460 20 HDG	500	29.49	1
KATR4 470 20 HDG	600	34.74	1
KATR4 475 20 HDG	700	40.31	1
KATR4 480 20 HDG	800	46.19	1
KATR4 490 20 HDG	900	52.38	1
KATR4 400 20 HDG	1000	58.89	1

APPLICATIONS

Cable routing

MATERIAL

HDG-steel, hot-dip galv. to TS-EN ISO 1461:2011 (HDG)

Available finishes:

Steel, strip-galv. acc. to the Sendzimir method to TS-EN 10346:2011 (PG)
 SS- stainless steel AISI 304L and AISI 316L (SS)
 EP- powder coating in a full range of colours (RAL)

Thickn. (ga) [mm]: **1.5 2.0**

Cable Trays - System of Side Height H40

Cross Bend of Cable Tray

4'lü Kanal Bağlantı Elemanı- Крестовина

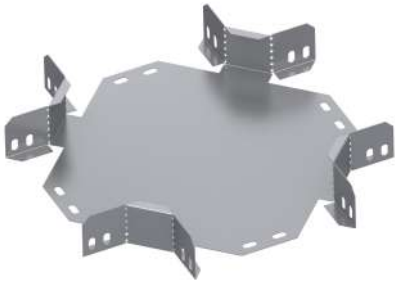

Important!

To install cable tray - bend use Screw Sets CFS M6 or CFS M8

Hot-Dip Galvanized

KAD ... H40				1.0mm	
CODE	Width a=b=c=d mm	Kg ad/pc	pcs		
KAD 405 10 HDG	50	0.35	1		
KAD 407 10 HDG	75	0.57	1		
KAD 410 10 HDG	100	0.67	1		
KAD 412 10 HDG	125	0.77	1		
KAD 415 10 HDG	150	0.89	1		
KAD 420 10 HDG	200	1.36	1		
				1.5mm	
KAD 405 15 HDG	50	0.53	1		
KAD 407 15 HDG	75	0.85	1		
KAD 410 15 HDG	100	1.00	1		
KAD 412 15 HDG	125	1.16	1		
KAD 415 15 HDG	150	1.33	1		
KAD 420 15 HDG	200	2.04	1		
KAD 422 15 HDG	225	2.27	1		
KAD 425 15 HDG	250	2.50	1		
KAD 430 15 HDG	300	3.01	1		
KAD 440 15 HDG	400	4.17	1		
KAD 445 15 HDG	450	4.82	1		
KAD 450 15 HDG	500	5.52	1		
KAD 460 15 HDG	600	7.05	1		
KAD 470 15 HDG	700	8.78	1		
KAD 475 15 HDG	750	9.71	1		
KAD 480 15 HDG	800	10.69	1		
KAD 490 15 HDG	900	12.79	1		
KAD 400 15 HDG	1000	15.08	1		

KAD ... H40				1.2mm	
CODE	Width a=b=c=d mm	Kg ad/pc	pcs		
KAD 405 12 HDG	50	0.42	1		
KAD 407 12 HDG	75	0.68	1		
KAD 410 12 HDG	100	0.80	1		
KAD 412 12 HDG	125	0.93	1		
KAD 415 12 HDG	150	1.06	1		
KAD 420 12 HDG	200	1.63	1		
KAD 422 12 HDG	150	1.53	1		
KAD 425 12 HDG	200	1.71	1		
KAD 430 12 HDG	300	2.41	1		
				2.0mm	
KAD 405 20 HDG	50	0.70	1		
KAD 407 20 HDG	75	1.14	1		
KAD 410 20 HDG	100	1.33	1		
KAD 412 20 HDG	125	1.54	1		
KAD 415 20 HDG	150	1.77	1		
KAD 420 20 HDG	200	2.72	1		
KAD 422 20 HDG	225	3.02	1		
KAD 425 20 HDG	250	3.34	1		
KAD 430 20 HDG	300	4.01	1		
KAD 440 20 HDG	400	5.56	1		
KAD 445 20 HDG	450	6.43	1		
KAD 450 20 HDG	500	7.36	1		
KAD 460 20 HDG	600	9.40	1		
KAD 470 20 HDG	700	11.70	1		
KAD 475 20 HDG	750	12.94	1		
KAD 480 20 HDG	800	14.25	1		
KAD 490 20 HDG	900	17.05	1		
KAD 400 20 HDG	1000	20.10	1		

Cross Bend of Cable Tray Radius:150

4'lü Kanal Bağlantı Elemanı Radyus:150 - Крестовина:Радиус:150



Important!

To install cable tray - bend use Screw Sets CFS M6 or CFS M8

Hot-Dip Galvanized

KADR1 ... H40				1.5mm	
CODE	Width a=b=c=d mm	Kg ad/pc	pcs		
KADR1 405 15 HDG	50	1.40	1		
KADR1 407 15 HDG	75	1.59	1		
KADR1 410 15 HDG	100	1.79	1		
KADR1 412 15 HDG	125	2.00	1		
KADR1 415 15 HDG	150	2.22	1		
KADR1 420 15 HDG	200	2.70	1		
KADR1 422 15 HDG	225	2.96	1		
KADR1 425 15 HDG	250	3.23	1		
KADR1 430 15 HDG	300	3.80	1		
KADR1 440 15 HDG	400	5.09	1		
KADR1 445 15 HDG	450	5.81	1		
KADR1 450 15 HDG	500	6.57	1		
KADR1 460 15 HDG	600	8.24	1		
KADR1 470 15 HDG	700	10.10	1		
KADR1 475 15 HDG	750	11.09	1		
KADR1 480 15 HDG	800	12.14	1		
KADR1 490 15 HDG	900	14.37	1		
KADR1 400 15 HDG	1000	16.79	1		

KADR1 ... H40				2.0mm	
CODE	Width a=b=c=d mm	Kg ad/pc	pcs		
KADR1 405 20 HDG	50	1.87	1		
KADR1 407 20 HDG	75	2.12	1		
KADR1 410 20 HDG	100	2.38	1		
KADR1 412 20 HDG	125	2.66	1		
KADR1 415 20 HDG	150	2.96	1		
KADR1 420 20 HDG	200	3.60	1		
KADR1 422 20 HDG	225	3.94	1		
KADR1 425 20 HDG	250	4.30	1		
KADR1 430 20 HDG	300	5.07	1		
KADR1 440 20 HDG	400	6.79	1		
KADR1 445 20 HDG	450	7.74	1		
KADR1 450 20 HDG	500	8.76	1		
KADR1 460 20 HDG	600	10.99	1		
KADR1 470 20 HDG	700	13.46	1		
KADR1 475 20 HDG	750	14.79	1		
KADR1 480 20 HDG	800	16.19	1		
KADR1 490 20 HDG	900	19.16	1		
KADR1 400 20 HDG	1000	22.39	1		

KAD H40 HDG

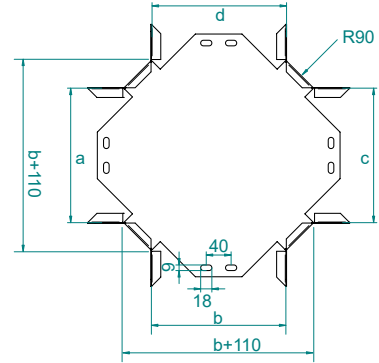

KADR1 H40

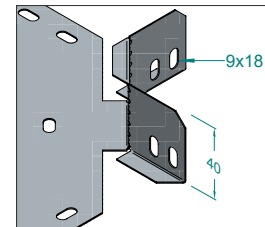
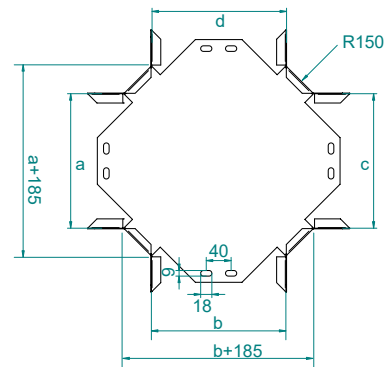

APPLICATIONS

Cable routing

MATERIAL

HDG-steel, hot-dip galv. to TS-EN ISO 1461:2011 (HDG)

Available finishes:

Steel, strip-galv. acc. to the Sendzimir method to TS-EN 10346:2011 (PG)
SS- stainless steel AISI 304L and AISI 316L (SS)
EP- powder coating in a full range of colours (RAL)

Thickn. (ga) [mm]: 1.0 1.2 1.5 2.0

Cable Trays - System of Side Height H40

Cross Bend of Cable Tray Radius:300

4'lü Kanal Bağlantı Elemanı Radyus:300 - Крестовина:Радиус:300

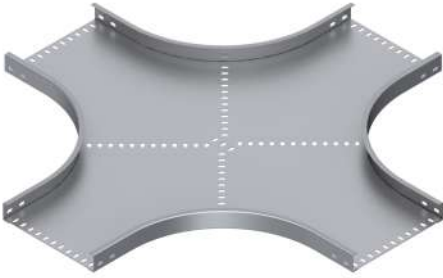

Important!

To install bend - use 8 pieces of KBE con. and 32 sets of CFS bolts and nuts (M6 or M8).

Hot-Dip Galvanized

KADR2 ... H40		1.5mm	
CODE	Width a=b=c=d mm	kg ad/pc	pcs
KADR2 405 15 HDG	50	5.40	1
KADR2 407 15HDG	75	5.94	1
KADR2 410 15 HDG	100	6.49	1
KADR2 412 15 HDG	125	7.06	1
KADR2 415 15 HDG	150	7.64	1
KADR2 420 15 HDG	200	8.84	1
KADR2 422 15 HDG	225	9.47	1
KADR2 425 15 HDG	250	10.11	1
KADR2 430 15 HDG	300	11.44	1
KADR2 440 15 HDG	400	14.26	1
KADR2 445 15 HDG	450	15.76	1
KADR2 450 15 HDG	500	17.32	1
KADR2 460 15 HDG	600	20.62	1
KADR2 470 15 HDG	700	24.15	1
KADR2 475 15 HDG	750	26.01	1
KADR2 480 15 HDG	800	27.92	1
KADR2 490 15 HDG	900	31.92	1
KADR2 400 15 HDG	1000	36.16	1

KADR2 ... H40		2.0mm	
CODE	Width a=b=c=d mm	kg ad/pc	pcs
KADR2 405 20 HDG	50	7.20	1
KADR2 407 20 HDG	75	7.91	1
KADR2 410 20 HDG	100	8.65	1
KADR2 412 20 HDG	125	9.40	1
KADR2 415 20 HDG	150	10.18	1
KADR2 420 20 HDG	200	11.79	1
KADR2 422 20 HDG	225	12.62	1
KADR2 425 20 HDG	250	13.48	1
KADR2 430 20 HDG	300	15.24	1
KADR2 440 20 HDG	400	19.01	1
KADR2 445 20 HDG	450	21.01	1
KADR2 450 20 HDG	500	23.09	1
KADR2 460 20 HDG	600	27.49	1
KADR2 470 20 HDG	700	32.20	1
KADR2 475 20 HDG	750	34.67	1
KADR2 480 20 HDG	800	37.22	1
KADR2 490 20 HDG	900	42.56	1
KADR2 400 20 HDG	1000	48.21	1

KADR2 H40 HDG

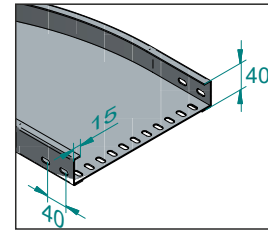
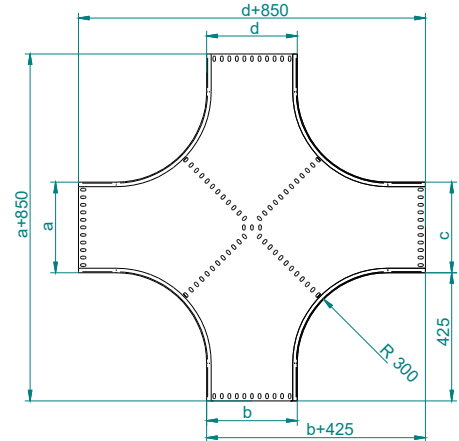

Cross Bend of Cable Tray Radius:600

4'lü Kanal Bağlantı Elemanı Radyus:600 - Крестовина:Радиус:600

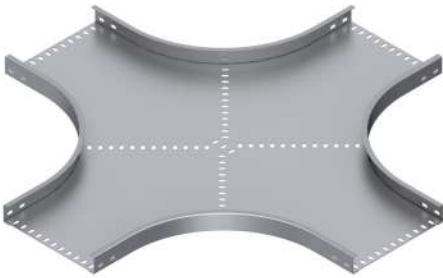

Important!

To install bend - use 8 pieces of KBE con. and 32 sets of CFS bolts and nuts (M6 or M8).

Hot-Dip Galvanized

KADR4 ... H40		1.5mm	
CODE	Width a=b=c=d mm	kg ad/pc	pcs
KADR4 405 15 HDG	50	11.26	1
KADR4 407 15 HDG	75	12.15	1
KADR4 410 15 HDG	100	13.06	1
KADR4 412 15 HDG	125	13.98	1
KADR4 415 15 HDG	150	14.91	1
KADR4 420 15 HDG	200	16.83	1
KADR4 422 15 HDG	225	17.80	1
KADR4 425 15 HDG	250	18.80	1
KADR4 430 15 HDG	300	20.83	1
KADR4 440 15 HDG	400	25.07	1
KADR4 445 15 HDG	450	27.28	1
KADR4 450 15 HDG	500	29.54	1
KADR4 460 15 HDG	600	34.25	1
KADR4 470 15 HDG	700	39.20	1
KADR4 475 15 HDG	750	41.76	1
KADR4 480 15 HDG	800	44.38	1
KADR4 490 15 HDG	900	49.80	1
KADR4 400 15 HDG	1000	55.45	1

KADR4 ... H40		2.0mm	
CODE	Width a=b=c=d mm	kg ad/pc	pcs
KADR4 405 20 HDG	50	15.01	1
KADR4 407 20 HDG	75	16.20	1
KADR4 410 20 HDG	100	17.41	1
KADR4 412 20 HDG	125	18.63	1
KADR4 415 20 HDG	150	19.88	1
KADR4 420 20 HDG	200	22.43	1
KADR4 422 20 HDG	225	23.74	1
KADR4 425 20 HDG	250	25.06	1
KADR4 430 20 HDG	300	27.77	1
KADR4 440 20 HDG	400	33.42	1
KADR4 445 20 HDG	450	36.37	1
KADR4 450 20 HDG	500	39.39	1
KADR4 460 20 HDG	600	45.67	1
KADR4 470 20 HDG	700	52.26	1
KADR4 475 20 HDG	750	55.68	1
KADR4 480 20 HDG	800	59.17	1
KADR4 490 20 HDG	900	66.39	1
KADR4 400 20 HDG	1000	73.93	1

KADR4 H40 HDG

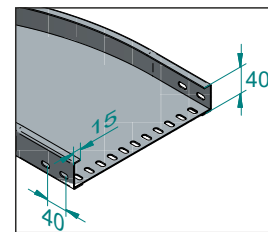
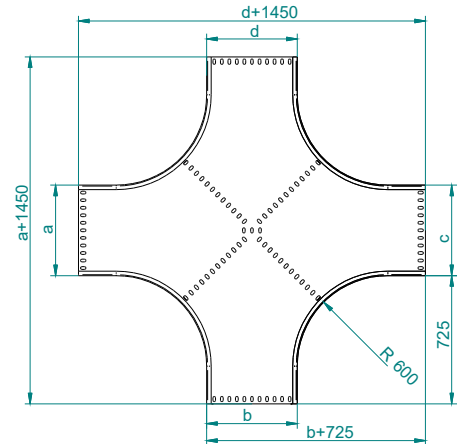

APPLICATIONS

Cable routing

MATERIAL

HDG-steel, hot-dip galv. to TS-EN ISO 1461:2011 (HDG)

Available finishes:

Steel, strip-galv. acc. to the Sendzimir method to TS-EN 10346:2011 (PG)
SS- stainless steel AISI 304L and AISI 316L (SS)
EP- powder coating in a full range of colours (RAL)

Thickn. (ga) [mm]: **1.5 2.0**

Cable Trays - System of Side Height H40

Add on tee horizontal bend

T yatay kanal dönüş eki - T-отвод горизонтальный врезной

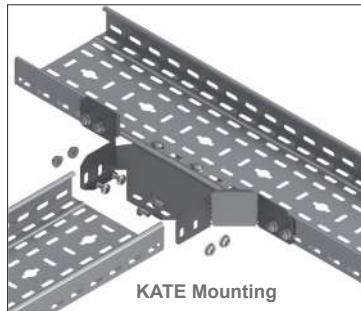

Important!

To install cable tray - bend use Screw Sets CFS M6 or CFS M8

Hot-Dip Galvanized

KATE ... H40			1.5mm	
CODE	Width a mm	Radius R mm	KG ad/pc	pcs
KATE 410 15 HDG	100	90	0.40	1
KATE 412 15 HDG	125	90	0.43	1
KATE 415 15 HDG	150	90	0.47	1
KATE 420 15 HDG	200	90	0.54	1
KATE 422 15 HDG	225	90	0.57	1
KATE 425 15 HDG	250	90	0.61	1
KATE 430 15 HDG	300	90	0.68	1
KATE 440 15 HDG	400	90	0.82	1
KATE 445 15 HDG	450	90	0.89	1
KATE 450 15 HDG	500	90	0.96	1
KATE 460 15 HDG	600	90	1.10	1
			2.0mm	
KATE 410 20 HDG	100	90	0.53	1
KATE 412 20 HDG	125	90	0.57	1
KATE 415 20 HDG	150	90	0.62	1
KATE 420 20 HDG	200	90	0.71	1
KATE 422 20 HDG	225	90	0.76	1
KATE 425 20 HDG	250	90	0.81	1
KATE 430 20 HDG	300	90	0.90	1
KATE 440 20 HDG	400	90	1.09	1
KATE 445 20 HDG	450	90	1.18	1
KATE 450 20 HDG	500	90	1.27	1
KATE 460 20 HDG	600	90	1.46	1

KATER1 ... H40			1.5mm	
CODE	Width a mm	Radius R mm	KG ad/pc	pcs
KATER1 410 15 HDG	100	150	0.76	1
KATER1 412 15 HDG	125	150	0.81	1
KATER1 415 15 HDG	150	150	0.87	1
KATER1 420 15 HDG	200	150	0.97	1
KATER1 422 15 HDG	225	150	1.03	1
KATER1 425 15 HDG	250	150	1.08	1
KATER1 430 15 HDG	300	150	1.19	1
KATER1 440 15 HDG	400	150	1.40	1
KATER1 445 15 HDG	450	150	1.51	1
KATER1 450 15 HDG	500	150	1.62	1
KATER1 460 15 HDG	600	150	1.83	1
			2.0mm	
KATER1 410 20 HDG	100	150	1.01	1
KATER1 412 20 HDG	125	150	1.08	1
KATER1 415 20 HDG	150	150	1.15	1
KATER1 420 20 HDG	200	150	1.30	1
KATER1 422 20 HDG	225	150	1.37	1
KATER1 425 20 HDG	250	150	1.44	1
KATER1 430 20 HDG	300	150	1.58	1
KATER1 440 20 HDG	400	150	1.87	1
KATER1 445 20 HDG	450	150	2.01	1
KATER1 450 20 HDG	500	150	2.16	1
KATER1 460 20 HDG	600	150	2.44	1

Add on 90° Horizontal Corner Bend

90° Köşe yatay kanal dönüş eki - Угол 90° врезной



Important!

To install cable tray - bend use Screw Sets CFS M6 or CFS M8

Hot-Dip Galvanized

KA90E ... H40			1.5mm	
CODE	a mm	Radius R mm	KG ad/pc	pcs
KA90E 5 15 HDG	55	90	0.22	1
KA90ER1 5 15 HDG	90	150	0.30	1
KA90ER2 5 15 HDG	180	300	0.55	1

KA90E ... H40			2.0mm	
CODE	a mm	Radius R mm	KG ad/pc	pcs
KA90E 5 20 HDG	55	90	0.28	1
KA90ER1 5 20 HDG	90	150	0.40	1
KA90ER2 5 20 HDG	180	300	0.74	1

KATE H40 HDG

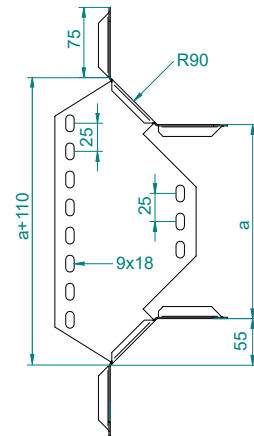

KATER1 H40 HDG

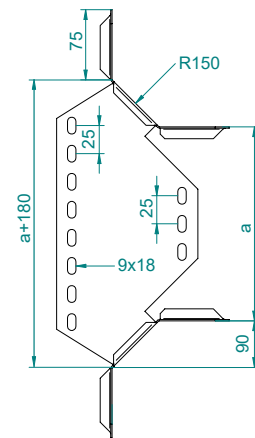

KA90E H40 HDG

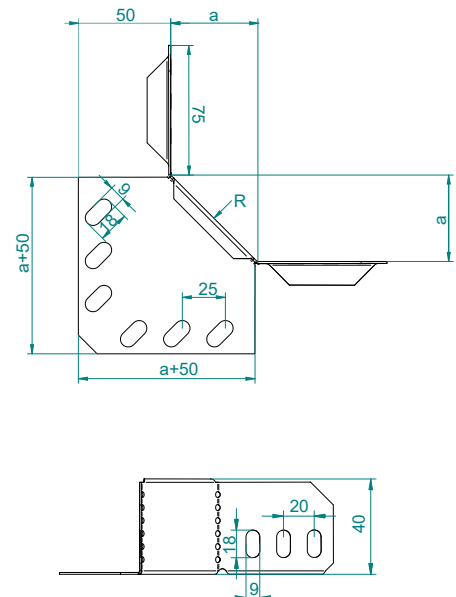

APPLICATIONS

Cable routing

MATERIAL

HDG-steel, hot-dip galv. to TS-EN ISO 1461:2011 (HDG)

Available finishes:

Steel, strip-galv. acc. to the Sendzimir method to TS-EN 10346:2011 (PG)
SS- stainless steel AISI 304L and AISI 316L (SS)
EP- powder coating in a full range of colours (RAL)

Thickn. (ga) [mm]: **1.5 2.0**

Cable Trays - System of Side Height H40

Middle Reducer Bend of Cable Tray

Kanal Ortadan Redüksiyon - Редукционный переходник, симметричный



Important!

To install cable tray - bend use Screw Sets
CFS M6 or CFS M8

Hot-Dip Galvanized

ROS ... H40		1.5mm		KG	PCS
CODE	W1 mm	W2 mm	ad/pc		
ROS 410.05 15 HDG	100	50	0.58	1	
ROS 415.10 15 HDG	150	100	0.75	1	
ROS 415.05 15 HDG	150	50	0.66	1	
ROS 420.15 15 HDG	200	150	0.91	1	
ROS 420.10 15 HDG	200	100	0.83	1	
ROS 420.05 15 HDG	200	50	0.75	1	
ROS 425.20 15 HDG	250	200	1.08	1	
ROS 425.15 15 HDG	250	150	0.99	1	
ROS 425.10 15 HDG	250	100	0.91	1	
ROS 425.05 15 HDG	250	50	0.83	1	
ROS 430.25 15 HDG	300	250	1.24	1	
ROS 430.20 15 HDG	300	200	1.16	1	
ROS 430.15 15 HDG	300	150	1.08	1	
ROS 430.10 15 HDG	300	100	0.99	1	
ROS 430.05 15 HDG	300	50	0.91	1	
ROS 440.30 15 HDG	400	300	1.70	1	
ROS 440.25 15 HDG	400	250	1.61	1	
ROS 440.20 15 HDG	400	200	1.51	1	
ROS 440.15 15 HDG	400	150	1.42	1	
ROS 440.10 15 HDG	400	100	1.32	1	
ROS 440.05 15 HDG	400	50	1.23	1	
ROS 445.40 15 HDG	450	400	2.23	1	
ROS 445.30 15 HDG	450	300	2.02	1	
ROS 445.25 15 HDG	450	250	1.91	1	
ROS 445.20 15 HDG	450	200	1.81	1	
ROS 445.15 15 HDG	450	150	1.70	1	
ROS 445.10 15 HDG	450	100	1.59	1	
ROS 445.05 15 HDG	450	50	1.49	1	
ROS 450.45 15 HDG	500	450	2.71	1	
ROS 450.40 15 HDG	500	400	2.60	1	
ROS 450.30 15 HDG	500	300	2.36	1	
ROS 450.25 15 HDG	500	250	2.24	1	
ROS 450.20 15 HDG	500	200	2.12	1	
ROS 450.15 15 HDG	500	150	2.01	1	
ROS 450.10 15 HDG	500	100	1.89	1	
ROS 450.05 15 HDG	500	50	1.77	1	
ROS 460.50 15 HDG	600	500	3.68	1	
ROS 460.45 15 HDG	600	450	3.54	1	
ROS 460.40 15 HDG	600	400	3.40	1	
ROS 460.30 15 HDG	600	300	3.11	1	
ROS 460.25 15 HDG	600	250	2.97	1	
ROS 460.20 15 HDG	600	200	2.83	1	
ROS 460.15 15 HDG	600	150	2.69	1	
ROS 460.10 15 HDG	600	100	2.55	1	
ROS 460.05 15 HDG	600	50	2.41	1	

ROS ... H40		2.0mm		KG	PCS
CODE	W1 mm	W2 mm	ad/pc		
ROS 410.05 20 HDG	100	50	0.77	1	
ROS 415.10 20 HDG	150	100	0.99	1	
ROS 415.05 20 HDG	150	50	0.88	1	
ROS 420.15 20 HDG	200	150	1.21	1	
ROS 420.10 20 HDG	200	100	1.10	1	
ROS 420.05 20 HDG	200	50	0.99	1	
ROS 425.20 20 HDG	250	200	1.43	1	
ROS 425.15 20 HDG	250	150	1.32	1	
ROS 425.10 20 HDG	250	100	1.21	1	
ROS 425.05 20 HDG	250	50	1.10	1	
ROS 430.25 20 HDG	300	250	1.65	1	
ROS 430.20 20 HDG	300	200	1.54	1	
ROS 430.15 20 HDG	300	150	1.43	1	
ROS 430.10 20 HDG	300	100	1.32	1	
ROS 430.05 20 HDG	300	50	1.21	1	
ROS 440.30 20 HDG	400	300	2.27	1	
ROS 440.25 20 HDG	400	250	2.14	1	
ROS 440.20 20 HDG	400	200	2.01	1	
ROS 440.15 20 HDG	400	150	1.89	1	
ROS 440.10 20 HDG	400	100	1.76	1	
ROS 440.05 20 HDG	400	50	1.64	1	
ROS 445.40 20 HDG	450	400	2.97	1	
ROS 445.30 20 HDG	450	300	2.69	1	
ROS 445.25 20 HDG	450	250	2.55	1	
ROS 445.20 20 HDG	450	200	2.41	1	
ROS 445.15 20 HDG	450	150	2.27	1	
ROS 445.10 20 HDG	450	100	2.12	1	
ROS 445.05 20 HDG	450	50	1.98	1	
ROS 450.45 20 HDG	500	450	3.62	1	
ROS 450.40 20 HDG	500	400	3.46	1	
ROS 450.30 20 HDG	500	300	3.14	1	
ROS 450.25 20 HDG	500	250	2.99	1	
ROS 450.20 20 HDG	500	200	2.83	1	
ROS 450.15 20 HDG	500	150	2.67	1	
ROS 450.10 20 HDG	500	100	2.52	1	
ROS 450.05 20 HDG	500	50	2.36	1	
ROS 460.50 20 HDG	600	500	4.90	1	
ROS 460.45 20 HDG	600	450	4.71	1	
ROS 460.40 20 HDG	600	400	4.53	1	
ROS 460.30 20 HDG	600	300	4.15	1	
ROS 460.25 20 HDG	600	250	3.96	1	
ROS 460.20 20 HDG	600	200	3.77	1	
ROS 460.15 20 HDG	600	150	3.58	1	
ROS 460.10 20 HDG	600	100	3.40	1	
ROS 460.05 20 HDG	600	50	3.21	1	

ROS H40 HDG

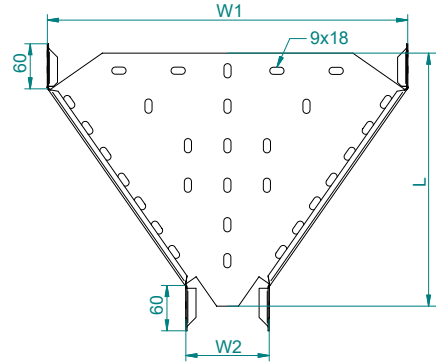

W1 100 - 300mm (L=200mm)

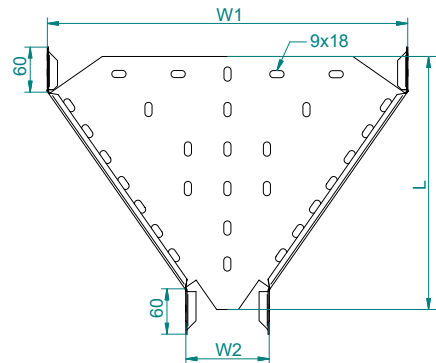

W1 400 - 600mm (L=300mm)

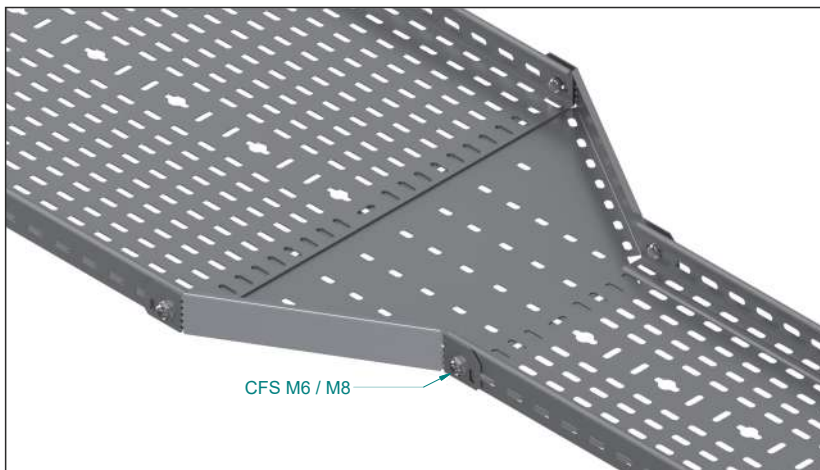

CFS M6 / M8

APPLICATIONS

Cable routing

MATERIAL

HDG-steel, hot-dip galv. to TS-EN ISO 1461:2011 (HDG)

Available finishes:

Steel, strip-galv. acc. to the Sendzimir method to TS-EN 10346:2011 (PG)
SS- stainless steel AISI 304L and AISI 316L (SS)
EP- powder coating in a full range of colours (RAL)

Thickn. (ga) [mm]: 1.5 2.0

Cable Trays - System of Side Height H40

Left Reducer Bend of Cable Tray

Kanal Soldan Redüksiyon - Редукционный переходник, левосторонний



Important!

To install cable tray - bend use Screw Sets
CFS M6 or CFS M8

Hot-Dip Galvanized

RLS ... H40		1.5mm		
CODE	W1 mm	W2 mm	kg/ad/pc	pcs
RLS 410.05 15 HDG	100	50	0.58	1
RLS 415.10 15 HDG	150	100	0.75	1
RLS 415.05 15 HDG	150	50	0.66	1
RLS 420.15 15 HDG	200	150	0.91	1
RLS 420.10 15 HDG	200	100	0.83	1
RLS 420.05 15 HDG	200	50	0.75	1
RLS 425.20 15 HDG	250	200	1.08	1
RLS 425.15 15 HDG	250	150	0.99	1
RLS 425.10 15 HDG	250	100	0.91	1
RLS 425.05 15 HDG	250	50	0.83	1
RLS 430.25 15 HDG	300	250	1.24	1
RLS 430.20 15 HDG	300	200	1.16	1
RLS 430.15 15 HDG	300	150	1.08	1
RLS 430.10 15 HDG	300	100	0.99	1
RLS 430.05 15 HDG	300	50	0.91	1
RLS 440.30 15 HDG	400	300	1.70	1
RLS 440.25 15 HDG	400	250	1.61	1
RLS 440.20 15 HDG	400	200	1.51	1
RLS 440.15 15 HDG	400	150	1.42	1
RLS 440.10 15 HDG	400	100	1.32	1
RLS 440.05 15 HDG	400	50	1.23	1
RLS 445.40 15 HDG	450	400	2.02	1
RLS 445.30 15 HDG	450	300	1.91	1
RLS 445.25 15 HDG	450	250	1.99	1
RLS 445.20 15 HDG	450	200	1.81	1
RLS 445.15 15 HDG	450	150	1.70	1
RLS 445.10 15 HDG	450	100	1.59	1
RLS 445.05 15 HDG	450	50	1.49	1
RLS 450.45 15 HDG	500	450	2.71	1
RLS 450.40 15 HDG	500	400	2.60	1
RLS 450.30 15 HDG	500	300	2.36	1
RLS 450.25 15 HDG	500	250	2.24	1
RLS 450.20 15 HDG	500	200	2.12	1
RLS 450.15 15 HDG	500	150	2.01	1
RLS 450.10 15 HDG	500	100	1.89	1
RLS 450.05 15 HDG	500	50	1.77	1
RLS 460.50 15 HDG	600	500	3.68	1
RLS 460.45 15 HDG	600	450	3.54	1
RLS 460.40 15 HDG	600	400	3.40	1
RLS 460.30 15 HDG	600	300	3.11	1
RLS 460.25 15 HDG	600	250	2.97	1
RLS 460.20 15 HDG	600	200	2.83	1
RLS 460.15 15 HDG	600	150	2.69	1
RLS 460.10 15 HDG	600	100	2.55	1
RLS 460.05 15 HDG	600	50	2.41	1

RLS ... H40		2.0mm		
CODE	W1 mm	W2 mm	kg/ad/pc	pcs
RLS 410.05 20 HDG	100	50	0.77	1
RLS 415.10 20 HDG	150	100	0.99	1
RLS 415.05 20 HDG	150	50	0.88	1
RLS 420.15 20 HDG	200	150	1.21	1
RLS 420.10 20 HDG	200	100	1.10	1
RLS 420.05 20 HDG	200	50	0.99	1
RLS 425.20 20 HDG	250	200	1.43	1
RLS 425.15 20 HDG	250	150	1.32	1
RLS 425.10 20 HDG	250	100	1.21	1
RLS 425.05 20 HDG	250	50	1.10	1
RLS 430.25 20 HDG	300	250	1.65	1
RLS 430.20 20 HDG	300	200	1.54	1
RLS 430.15 20 HDG	300	150	1.43	1
RLS 430.10 20 HDG	300	100	1.32	1
RLS 430.05 20 HDG	300	50	1.21	1
RLS 440.30 20 HDG	400	300	2.27	1
RLS 440.25 20 HDG	400	250	2.14	1
RLS 440.20 20 HDG	400	200	2.01	1
RLS 440.15 20 HDG	400	150	1.89	1
RLS 440.10 20 HDG	400	100	1.76	1
RLS 440.05 20 HDG	400	50	1.64	1
RLS 445.40 20 HDG	450	400	2.97	1
RLS 445.30 20 HDG	450	300	2.69	1
RLS 445.25 20 HDG	450	250	2.55	1
RLS 445.20 20 HDG	450	200	2.41	1
RLS 445.15 20 HDG	450	150	2.27	1
RLS 445.10 20 HDG	450	100	2.12	1
RLS 445.05 20 HDG	450	50	1.98	1
RLS 450.45 20 HDG	500	450	3.62	1
RLS 450.40 20 HDG	500	400	3.46	1
RLS 450.30 20 HDG	500	300	3.14	1
RLS 450.25 20 HDG	500	250	2.99	1
RLS 450.20 20 HDG	500	200	2.83	1
RLS 450.15 20 HDG	500	150	2.67	1
RLS 450.10 20 HDG	500	100	2.52	1
RLS 450.05 20 HDG	500	50	2.36	1
RLS 460.50 20 HDG	600	500	4.90	1
RLS 460.45 20 HDG	600	450	4.71	1
RLS 460.40 20 HDG	600	400	4.53	1
RLS 460.30 20 HDG	600	300	4.15	1
RLS 460.25 20 HDG	600	250	3.96	1
RLS 460.20 20 HDG	600	200	3.77	1
RLS 460.15 20 HDG	600	150	3.58	1
RLS 460.10 20 HDG	600	100	3.40	1
RLS 460.05 20 HDG	600	50	3.21	1

RLS H40 HDG

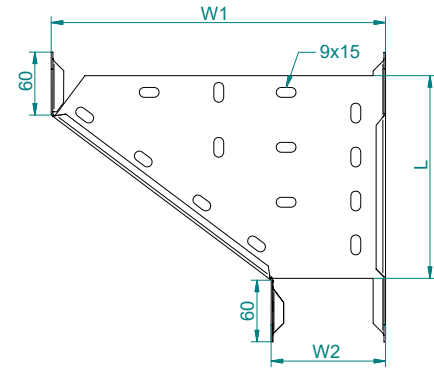

W1 100 - 300mm (L=200mm)

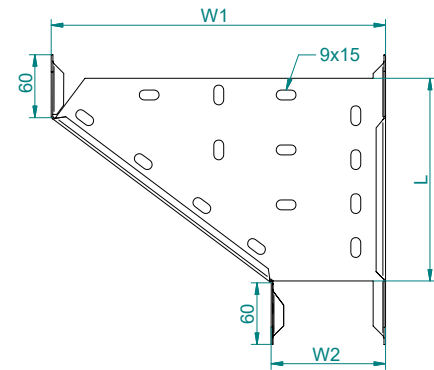

W1 400 - 600mm (L=300mm)



APPLICATIONS
Cable routing

MATERIAL
HDG-steel, hot-dip galv. to TS-EN ISO 1461:2011 (HDG)

Available finishes:
Steel, strip-galv. acc. to the Sendzimir method to TS-EN 10346:2011 (PG)
SS- stainless steel AISI 304L and AISI 316L (SS)
EP- powder coating in a full range of colours (RAL)

Thickn. (ga) [mm]: 1.5 2.0

Cable Trays - System of Side Height H40

Right Reducer Bend of Cable Tray

Kanal Sağdan Redüksiyon - Редукционный переходник, правосторонний



Important!

To install cable tray - bend use Screw Sets CFS M6 or CFS M8

Hot-Dip Galvanized

RGS ... H40		1.5mm		kg/ad/pc	pcs
CODE	W1 mm	W2 mm			
RGS 410.05 15 HDG	100	50	0.58	1	
RGS 415.10 15 HDG	150	100	0.75	1	
RGS 415.05 15 HDG	150	50	0.66	1	
RGS 420.15 15 HDG	200	150	0.91	1	
RGS 420.10 15 HDG	200	100	0.83	1	
RGS 420.05 15 HDG	200	50	0.75	1	
RGS 425.20 15 HDG	250	200	1.08	1	
RGS 425.15 15 HDG	250	150	0.99	1	
RGS 425.10 15 HDG	250	100	0.91	1	
RGS 425.05 15 HDG	250	50	0.83	1	
RGS 430.25 15 HDG	300	250	1.24	1	
RGS 430.20 15 HDG	300	200	1.16	1	
RGS 430.15 15 HDG	300	150	1.08	1	
RGS 430.10 15 HDG	300	100	0.99	1	
RGS 430.05 15 HDG	300	50	0.91	1	
RGS 440.30 15 HDG	400	300	1.70	1	
RGS 440.25 15 HDG	400	250	1.61	1	
RGS 440.20 15 HDG	400	200	1.51	1	
RGS 440.15 15 HDG	400	150	1.42	1	
RGS 440.10 15 HDG	400	100	1.32	1	
RGS 440.05 15 HDG	400	50	1.23	1	
RGS 445.40 15 HDG	450	400	2.23	1	
RGS 445.30 15 HDG	450	300	2.02	1	
RGS 445.25 15 HDG	450	250	1.91	1	
RGS 445.20 15 HDG	450	200	1.81	1	
RGS 445.15 15 HDG	450	150	1.70	1	
RGS 445.10 15 HDG	450	100	1.59	1	
RGS 445.05 15 HDG	450	50	1.49	1	
RGS 450.45 15 HDG	500	450	2.71	1	
RGS 450.40 15 HDG	500	400	2.60	1	
RGS 450.30 15 HDG	500	300	2.36	1	
RGS 450.25 15 HDG	500	250	2.24	1	
RGS 450.20 15 HDG	500	200	2.12	1	
RGS 450.15 15 HDG	500	150	2.01	1	
RGS 450.10 15 HDG	500	100	1.89	1	
RGS 450.05 15 HDG	500	50	1.77	1	
RGS 460.50 15 HDG	600	500	3.68	1	
RGS 460.45 15 HDG	600	450	3.54	1	
RGS 460.40 15 HDG	600	400	3.40	1	
RGS 460.30 15 HDG	600	300	3.11	1	
RGS 460.25 15 HDG	600	250	2.97	1	
RGS 460.20 15 HDG	600	200	2.83	1	
RGS 460.15 15 HDG	600	150	2.69	1	
RGS 460.10 15 HDG	600	100	2.55	1	
RGS 460.05 15 HDG	600	50	2.41	1	

RGS ... H40		2.0mm		kg/ad/pc	pcs
CODE	W1 mm	W2 mm			
RGS 410.05 20 HDG	100	50	0.77	1	
RGS 415.10 20 HDG	150	100	0.99	1	
RGS 415.05 20 HDG	150	50	0.88	1	
RGS 420.15 20 HDG	200	150	1.21	1	
RGS 420.10 20 HDG	200	100	1.10	1	
RGS 420.05 20 HDG	200	50	0.99	1	
RGS 425.20 20 HDG	250	200	1.43	1	
RGS 425.15 20 HDG	250	150	1.32	1	
RGS 425.10 20 HDG	250	100	1.21	1	
RGS 425.05 20 HDG	250	50	1.10	1	
RGS 430.25 20 HDG	300	250	1.65	1	
RGS 430.20 20 HDG	300	200	1.54	1	
RGS 430.15 20 HDG	300	150	1.43	1	
RGS 430.10 20 HDG	300	100	1.32	1	
RGS 430.05 20 HDG	300	50	1.21	1	
RGS 440.30 20 HDG	400	300	2.27	1	
RGS 440.25 20 HDG	400	250	2.14	1	
RGS 440.20 20 HDG	400	200	2.01	1	
RGS 440.15 20 HDG	400	150	1.89	1	
RGS 440.10 20 HDG	400	100	1.76	1	
RGS 440.05 20 HDG	400	50	1.64	1	
RGS 445.40 20 HDG	450	400	2.97	1	
RGS 445.30 20 HDG	450	300	2.69	1	
RGS 445.25 20 HDG	450	250	2.55	1	
RGS 445.20 20 HDG	450	200	2.41	1	
RGS 445.15 20 HDG	450	150	2.27	1	
RGS 445.10 20 HDG	450	100	2.12	1	
RGS 445.05 20 HDG	450	50	1.98	1	
RGS 450.45 20 HDG	500	450	3.62	1	
RGS 450.40 20 HDG	500	400	3.46	1	
RGS 450.30 20 HDG	500	300	3.14	1	
RGS 450.25 20 HDG	500	250	2.99	1	
RGS 450.20 20 HDG	500	200	2.83	1	
RGS 450.15 20 HDG	500	150	2.67	1	
RGS 450.10 20 HDG	500	100	2.52	1	
RGS 450.05 20 HDG	500	50	2.36	1	
RGS 460.50 20 HDG	600	500	4.90	1	
RGS 460.45 20 HDG	600	450	4.71	1	
RGS 460.40 20 HDG	600	400	4.53	1	
RGS 460.30 20 HDG	600	300	4.15	1	
RGS 460.25 20 HDG	600	250	4.96	1	
RGS 460.20 20 HDG	600	200	3.77	1	
RGS 460.15 20 HDG	600	150	3.58	1	
RGS 460.10 20 HDG	600	100	3.40	1	
RGS 460.05 20 HDG	600	50	3.21	1	

RGS H40 HDG

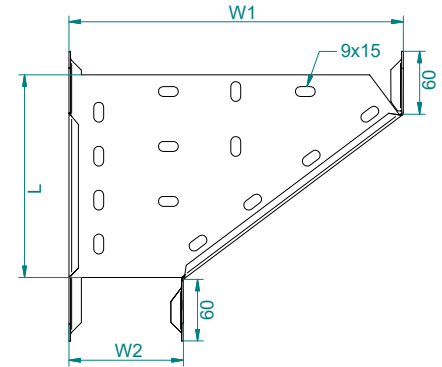

W1 100 - 300mm (L=200mm)

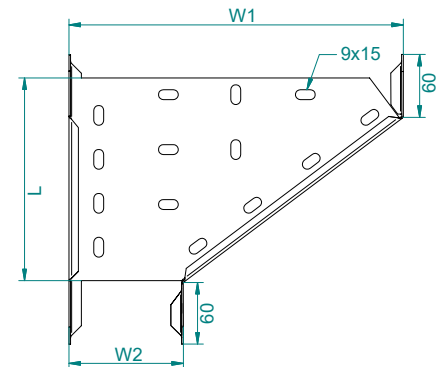

W1 400 - 600mm (L=300mm)

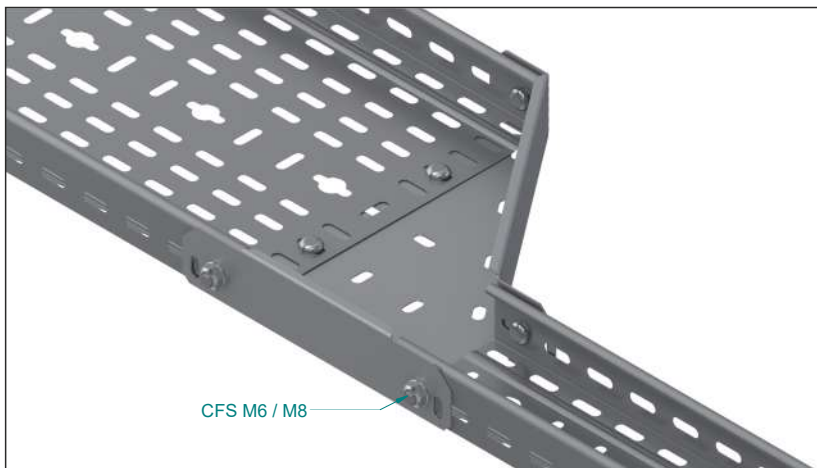

CFS M6 / M8

APPLICATIONS

Cable routing

MATERIAL

HDG-steel, hot-dip galv. to TS-EN ISO 1461:2011 (HDG)

Available finishes:

Steel, strip-galv. acc. to the Sendzimir method to TS-EN 10346:2011 (PG)
SS- stainless steel AISI 304L and AISI 316L (SS)
EP- powder coating in a full range of colours (RAL)

Thickn. (ga) [mm]: 1.5 2.0

Cable Trays - System of Side Height H40

Vertical Outside Bend of Cable Tray (Flexible)

Kanal Dış Bükme - Арка универсальная, внешний изгиб



Important!

To install vertical bend - use 2 pieces of KBE con. and 4 sets of CFS bolts and nuts (M6 or M8).

Hot-Dip Galvanized

KADB ... H40		1.0mm	
CODE	Width a mm	Kg ad/pc	pcs
KADB 405 10 HDG	50	0.58	1
KADB 407 10 HDG	75	0.68	1
KADB 410 10 HDG	100	0.78	1
KADB 412 10 HDG	125	0.88	1
KADB 415 10 HDG	150	0.97	1
KADB 420 10 HDG	200	1.17	1
KADB ... H40		1.5mm	
CODE	Width a mm	Kg ad/pc	pcs
KADB 405 15 HDG	50	0.85	1
KADB 407 15 HDG	75	1.00	1
KADB 410 15 HDG	100	1.15	1
KADB 412 15 HDG	125	1.30	1
KADB 415 15 HDG	150	1.40	1
KADB 420 15 HDG	200	1.74	1
KADB 422 15 HDG	225	1.84	1
KADB 425 15 HDG	250	2.04	1
KADB 430 15 HDG	300	2.32	1
KADB 440 15 HDG	400	2.92	1
KADB 445 15 HDG	450	3.21	1
KADB 450 15 HDG	500	3.51	1
KADB 460 15 HDG	600	4.09	1
KADB 470 15 HDG	700	5.62	1
KADB 475 15 HDG	750	5.97	1
KADB 480 15 HDG	800	6.32	1
KADB 490 15 HDG	900	7.03	1
KADB 400 15 HDG	1000	7.74	1

KADB ... H40		1.2mm	
CODE	Width a mm	Kg ad/pc	pcs
KADB 405 12 HDG	50	0.69	1
KADB 407 12 HDG	75	0.81	1
KADB 410 12 HDG	100	0.93	1
KADB 412 12 HDG	125	1.05	1
KADB 415 12 HDG	150	1.16	1
KADB 420 12 HDG	200	1.40	1
KADB 422 12 HDG	225	1.52	1
KADB 425 12 HDG	250	1.64	1
KADB 430 12 HDG	300	1.88	1
KADB ... H40		2.0mm	
CODE	Width a mm	Kg ad/pc	pcs
KADB 405 20 HDG	50	1.12	1
KADB 407 20 HDG	75	1.32	1
KADB 410 20 HDG	100	1.52	1
KADB 412 20 HDG	125	1.71	1
KADB 415 20 HDG	150	1.91	1
KADB 420 20 HDG	200	2.30	1
KADB 422 20 HDG	225	2.50	1
KADB 425 20 HDG	250	2.69	1
KADB 430 20 HDG	300	3.08	1
KADB 440 20 HDG	400	3.87	1
KADB 445 20 HDG	450	4.26	1
KADB 450 20 HDG	500	4.65	1
KADB 460 20 HDG	600	5.44	1
KADB 470 20 HDG	700	7.47	1
KADB 475 20 HDG	750	7.94	1
KADB 480 20 HDG	800	8.41	1
KADB 490 20 HDG	900	9.36	1
KADB 400 20 HDG	1000	10.29	1

Vertical Inside Bend of Cable Tray (Flexible)

Kanal İç Bükme - Арка универсальная, внутренний изгиб



Important!

To install vertical bend - use 2 pieces of KBE con. and 4 sets of CFS bolts and nuts (M6 or M8).

Hot-Dip Galvanized

KAIB ... H40		1.0mm	
CODE	Width a mm	Kg ad/pc	pcs
KAIB 405 10 HDG	50	0.58	1
KAIB 407 10 HDG	75	0.68	1
KAIB 410 10 HDG	100	0.78	1
KAIB 412 10 HDG	125	0.88	1
KAIB 415 10 HDG	150	0.97	1
KAIB 420 10 HDG	200	1.17	1
KAIB ... H40		1.5mm	
CODE	Width a mm	Kg ad/pc	pcs
KAIB 405 15 HDG	50	0.85	1
KAIB 407 15 HDG	75	1.00	1
KAIB 410 15 HDG	100	1.15	1
KAIB 412 15 HDG	125	1.30	1
KAIB 415 15 HDG	150	1.40	1
KAIB 420 15 HDG	200	1.74	1
KAIB 422 15 HDG	225	1.84	1
KAIB 425 15 HDG	250	2.04	1
KAIB 430 15 HDG	300	2.32	1
KAIB 440 15 HDG	400	2.92	1
KAIB 445 15 HDG	450	3.21	1
KAIB 450 15 HDG	500	3.51	1
KAIB 460 15 HDG	600	4.09	1
KAIB 470 15 HDG	700	5.62	1
KAIB 475 15 HDG	750	5.97	1
KAIB 480 15 HDG	800	6.32	1
KAIB 490 15 HDG	900	7.03	1
KAIB 400 15 HDG	1000	7.74	1

KAIB ... H40		1.2mm	
CODE	Width a mm	Kg ad/pc	pcs
KAIB 405 12 HDG	50	0.69	1
KAIB 407 12 HDG	75	0.81	1
KAIB 410 12 HDG	100	0.93	1
KAIB 412 12 HDG	125	1.05	1
KAIB 415 12 HDG	150	1.16	1
KAIB 420 12 HDG	200	1.40	1
KAIB 422 12 HDG	225	1.52	1
KAIB 425 12 HDG	250	1.64	1
KAIB 430 12 HDG	300	1.88	1
KAIB ... H40		2.0mm	
CODE	Width a mm	Kg ad/pc	pcs
KAIB 405 20 HDG	50	1.12	1
KAIB 407 20 HDG	75	1.32	1
KAIB 410 20 HDG	100	1.52	1
KAIB 412 20 HDG	125	1.71	1
KAIB 415 20 HDG	150	1.91	1
KAIB 420 20 HDG	200	2.30	1
KAIB 422 20 HDG	225	2.50	1
KAIB 425 20 HDG	250	2.69	1
KAIB 430 20 HDG	300	3.08	1
KAIB 440 20 HDG	400	3.87	1
KAIB 445 20 HDG	450	4.26	1
KAIB 450 20 HDG	500	4.65	1
KAIB 460 20 HDG	600	5.44	1
KAIB 470 20 HDG	700	7.47	1
KAIB 475 20 HDG	750	7.94	1
KAIB 480 20 HDG	800	8.41	1
KAIB 490 20 HDG	900	9.36	1
KAIB 400 20 HDG	1000	10.29	1

KADB H40 HDG

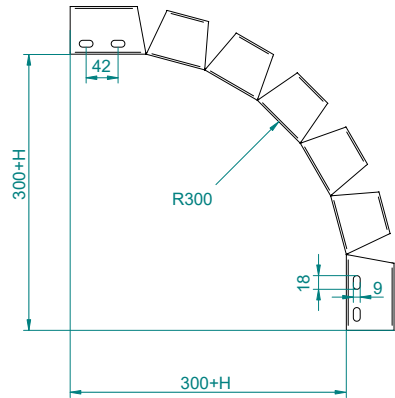
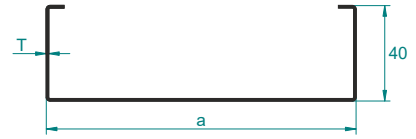

KADB and KAIB are the same items, shipped flat. To install - Bend manually during application. in Flat Length = 600mm

KAIB H40 HDG

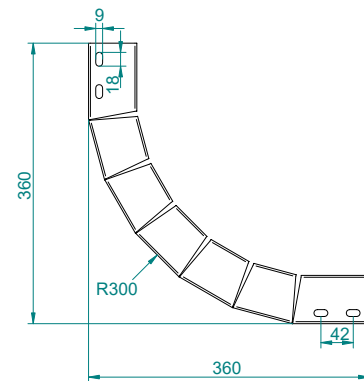
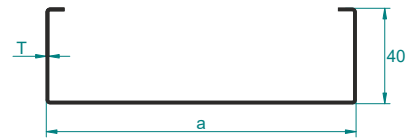

KADB and KAIB are the same items, shipped flat. To install - Bend manually during application. in Flat Length = 600mm

APPLICATIONS

Cable routing

MATERIAL

HDG-steel, hot-dip galv. to TS-EN ISO 1461:2011 (HDG)

Available finishes:

Steel, strip-galv. acc. to the Sendzimir method to TS-EN 10346:2011 (PG)
SS- stainless steel AISI 304L and AISI 316L (SS)
EP- powder coating in a full range of colours (RAL)

Thickn. (ga) [mm]: **1.0 1.2 1.5 2.0**

Cable Trays - System of Side Height H40

Vertical 90° Outside Bend of Cable Tray (Stable)

90° Dikey Kanal Dış Büküye Elemanı (Sabit) - Арка фиксированная, внешняя 90°



Important!

To install vertical bend - use 2 pieces of KBE con. and 4 sets of CFS bolts and nuts (M6 or M8).

Hot-Dip Galvanized

KADS ... H40		1.5mm	
CODE	Width a=b mm	kg ad/pc	pcs
KADS 405 15 HDG	50	0.68	1
KADS 407 15 HDG	75	0.80	1
KADS 410 15 HDG	100	0.92	1
KADS 412 15 HDG	125	1.04	1
KADS 415 15 HDG	150	1.16	1
KADS 420 15 HDG	200	1.40	1
KADS 422 15 HDG	225	1.51	1
KADS 425 15 HDG	250	1.63	1
KADS 430 15 HDG	300	1.86	1
KADS 440 15 HDG	400	2.33	1
KADS 445 15 HDG	450	2.57	1
KADS 450 15 HDG	500	2.80	1
KADS 460 15 HDG	600	3.28	1
KADS 470 15 HDG	700	4.49	1
KADS 475 15 HDG	750	4.78	1
KADS 480 15 HDG	800	5.06	1
KADS 490 15 HDG	900	5.63	1
KADS 400 15 HDG	1000	6.19	1

KADS ... H40		2.0mm	
CODE	Width a mm	kg ad/pc	pcs
KADS 405 20 HDG	50	0.90	1
KADS 407 20 HDG	75	1.06	1
KADS 410 20 HDG	100	1.21	1
KADS 412 20 HDG	125	1.37	1
KADS 415 20 HDG	150	1.52	1
KADS 420 20 HDG	200	1.84	1
KADS 422 20 HDG	225	2.00	1
KADS 425 20 HDG	250	2.16	1
KADS 430 20 HDG	300	2.47	1
KADS 440 20 HDG	400	3.10	1
KADS 445 20 HDG	450	3.41	1
KADS 450 20 HDG	500	3.72	1
KADS 460 20 HDG	600	4.36	1
KADS 470 20 HDG	700	5.98	1
KADS 475 20 HDG	750	6.36	1
KADS 480 20 HDG	800	6.73	1
KADS 490 20 HDG	900	7.48	1
KADS 400 20 HDG	1000	8.24	1

Vertical 90° Inside Bend of Cable Tray (stable)

90° Dikey Kanal İç Büküye Elemanı (Sabit)- Арка фиксированная, внутренняя 90°



Important!

To install vertical bend - use 2 pieces of KBE con. and 4 sets of CFS bolts and nuts (M6 or M8).

Hot-Dip Galvanized

KAIS ... H40		1.5mm	
CODE	Width a mm	kg ad/pc	pcs
KAIS 405 15 HDG	50	0.68	1
KAIS 407 15 HDG	75	0.80	1
KAIS 410 15 HDG	100	0.92	1
KAIS 412 15 HDG	125	1.04	1
KAIS 415 15 HDG	150	1.16	1
KAIS 420 15 HDG	200	1.40	1
KAIS 422 15 HDG	225	1.51	1
KAIS 425 15 HDG	250	1.63	1
KAIS 430 15 HDG	300	1.86	1
KAIS 440 15 HDG	400	2.33	1
KAIS 445 15 HDG	450	2.57	1
KAIS 450 15 HDG	500	2.80	1
KAIS 460 15 HDG	600	3.28	1
KAIS 470 15 HDG	700	4.49	1
KAIS 475 15 HDG	750	4.78	1
KAIS 480 15 HDG	800	5.06	1
KAIS 490 15 HDG	900	5.63	1
KAIS 400 15 HDG	1000	6.19	1

KAIS ... H40		2.0mm	
CODE	Width a mm	kg ad/pc	pcs
KAIS 405 20 HDG	50	0.90	1
KAIS 407 20 HDG	75	1.06	1
KAIS 410 20 HDG	100	1.21	1
KAIS 412 20 HDG	125	1.37	1
KAIS 415 20 HDG	150	1.52	1
KAIS 420 20 HDG	200	1.84	1
KAIS 422 20 HDG	225	2.00	1
KAIS 425 20 HDG	250	2.16	1
KAIS 430 20 HDG	300	2.47	1
KAIS 440 20 HDG	400	3.10	1
KAIS 445 20 HDG	450	3.41	1
KAIS 450 20 HDG	500	3.72	1
KAIS 460 20 HDG	600	4.36	1
KAIS 470 20 HDG	700	5.98	1
KAIS 475 20 HDG	750	6.36	1
KAIS 480 20 HDG	800	6.73	1
KAIS 490 20 HDG	900	7.48	1
KAIS 400 20 HDG	1000	8.24	1

KADS H40 HDG

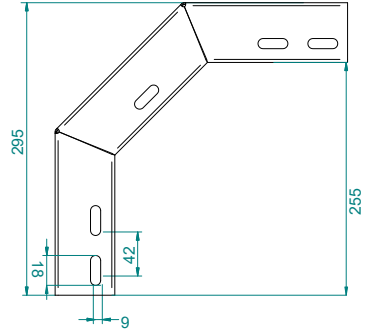
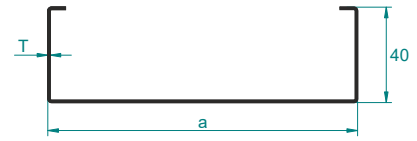

KAIS H40 HDG

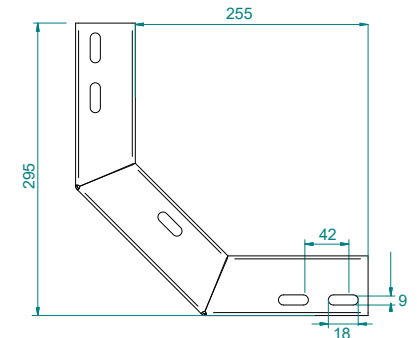
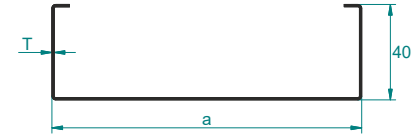

APPLICATIONS

Cable routing

MATERIAL

HDG-steel, hot-dip galv. to TS-EN ISO 1461:2011 (HDG)

Available finishes:

Steel, strip-galv. acc. to the Sendzimir method to TS-EN 10346:2011 (PG)
SS- stainless steel AISI 304L and AISI 316L (SS)
EP- powder coating in a full range of colours (RAL)

Thickn. (ga) [mm]: **1.5 2.0**

Cable Trays - System of Side Height H50

Vertical 90° Inside Bend of Cable Tray (Stable) Radius:300

90° Dikey Kanal İç Bükey Elemanı (Sabit) Radyus:300 - Арка фиксированная, внутренняя 90° Радиус:300



Hot-Dip Galvanized

KAISR2 ... H40		1.5mm	
CODE	Width a mm	Kg ad/pc	pcs
KAISR2 405 15 HDG	50	1.28	1
KAISR2 407 15 HDG	75	1.50	1
KAISR2 410 15 HDG	100	1.72	1
KAISR2 412 15 HDG	125	1.94	1
KAISR2 415 15 HDG	150	2.16	1
KAISR2 420 15 HDG	200	2.60	1
KAISR2 422 15 HDG	225	2.82	1
KAISR2 425 15 HDG	250	3.04	1
KAISR2 430 15 HDG	300	3.48	1
KAISR2 440 15 HDG	400	4.37	1
KAISR2 445 15 HDG	450	4.81	1
KAISR2 450 15 HDG	500	5.25	1
KAISR2 460 15 HDG	600	6.13	1
KAISR2 470 15 HDG	700	7.02	1
KAISR2 475 15 HDG	750	7.46	1
KAISR2 480 15 HDG	800	7.90	1
KAISR2 490 15 HDG	900	8.78	1
KAISR2 400 15 HDG	1000	9.67	1

Important!

To install vertical bend - use 4 pieces of KBE con. and 8 sets of CFS bolts and nuts (M6 or M8).

KAISR2 ... H40		2.0mm	
CODE	Width a mm	Kg ad/pc	pcs
KAISR2 405 20 HDG	50	1.68	1
KAISR2 407 20 HDG	75	1.97	1
KAISR2 410 20 HDG	100	2.27	1
KAISR2 412 20 HDG	125	2.56	1
KAISR2 415 20 HDG	150	2.85	1
KAISR2 420 20 HDG	200	3.44	1
KAISR2 422 20 HDG	225	3.74	1
KAISR2 425 20 HDG	250	4.03	1
KAISR2 430 20 HDG	300	4.62	1
KAISR2 440 20 HDG	400	5.80	1
KAISR2 445 20 HDG	450	6.39	1
KAISR2 450 20 HDG	500	6.98	1
KAISR2 460 20 HDG	600	8.15	1
KAISR2 470 20 HDG	700	9.33	1
KAISR2 475 20 HDG	750	9.92	1
KAISR2 480 20 HDG	800	10.51	1
KAISR2 490 20 HDG	900	11.69	1
KAISR2 400 20 HDG	1000	12.86	1

KAISR2 H40 HDG

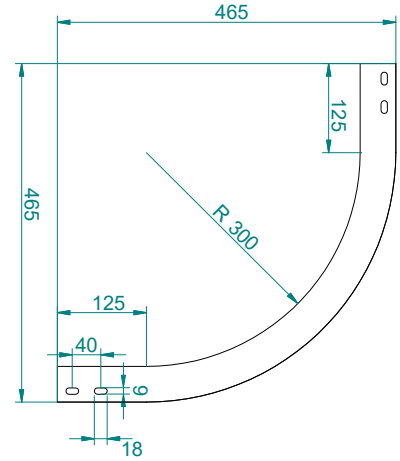
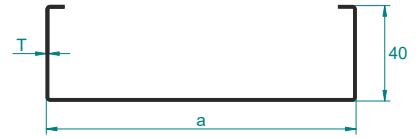

Vertical 90° Inside Bend of Cable Tray (Stable) Radius:600

90° Dikey Kanal İç Bükey Elemanı (Sabit) Radyus:600 - Арка фиксированная, внутренняя 90° Радиус:600



Hot-Dip Galvanized

KAISR4 ... H40		1.5mm	
CODE	Width a mm	Kg ad/pc	pcs
KAISR4 405 15 HDG	50	2.04	1
KAISR4 407 15 HDG	75	2.39	1
KAISR4 410 15 HDG	100	2.75	1
KAISR4 412 15 HDG	125	3.10	1
KAISR4 415 15 HDG	150	3.45	1
KAISR4 420 15 HDG	200	4.16	1
KAISR4 422 15 HDG	225	4.51	1
KAISR4 425 15 HDG	250	4.87	1
KAISR4 430 15 HDG	300	5.57	1
KAISR4 440 15 HDG	400	6.99	1
KAISR4 445 15 HDG	450	7.69	1
KAISR4 450 15 HDG	500	8.40	1
KAISR4 460 15 HDG	600	9.81	1
KAISR4 470 15 HDG	700	11.22	1
KAISR4 475 15 HDG	750	11.93	1
KAISR4 480 15 HDG	800	12.64	1
KAISR4 490 15 HDG	900	14.05	1
KAISR4 400 15 HDG	1000	15.46	1

Important!

To install vertical bend - use 4 pieces of KBE con. and 8 sets of CFS bolts and nuts (M6 or M8).

KAISR4 ... H40		2.0mm	
CODE	Width a mm	Kg ad/pc	pcs
KAISR4 405 20 HDG	50	2.68	1
KAISR4 407 20 HDG	75	3.15	1
KAISR4 410 20 HDG	100	3.62	1
KAISR4 412 20 HDG	125	4.09	1
KAISR4 415 20 HDG	150	4.56	1
KAISR4 420 20 HDG	200	5.51	1
KAISR4 422 20 HDG	225	5.98	1
KAISR4 425 20 HDG	250	6.45	1
KAISR4 430 20 HDG	300	7.39	1
KAISR4 440 20 HDG	400	9.27	1
KAISR4 445 20 HDG	450	10.22	1
KAISR4 450 20 HDG	500	11.16	1
KAISR4 460 20 HDG	600	13.04	1
KAISR4 470 20 HDG	700	14.93	1
KAISR4 475 20 HDG	750	15.87	1
KAISR4 480 20 HDG	800	16.81	1
KAISR4 490 20 HDG	900	18.69	1
KAISR4 400 20 HDG	1000	20.58	1

KAISR4 H40 HDG

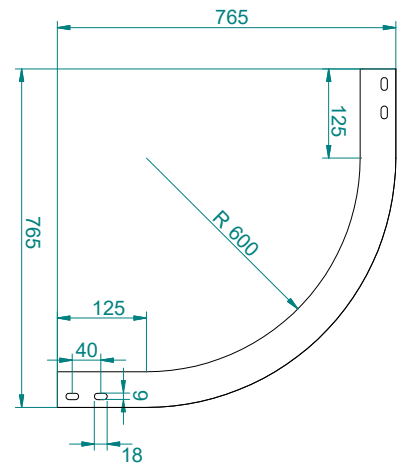
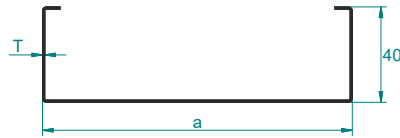

APPLICATIONS

Cable routing

MATERIAL

HDG-steel, hot-dip galv. to TS-EN ISO 1461:2011 (HDG)

Available finishes:

Steel, strip-galv. acc. to the Sendzimir method to TS-EN 10346:2011 (PG)
SS- stainless steel AISI 304L and AISI 316L (SS)
EP- powder coating in a full range of colours (RAL)

Thickn. (ga) [mm]: **1.5 2.0**

Cable Trays - System of Side Height H40

Vertical 90° Outside Bend of Cable Tray (Stable) Radius:300

90° Dikey Kanal Dış Bükey Elemanı (Sabit) Radyus:300 - Арка фиксированная, внешняя 90° радиус:300



Hot-Dip Galvanized

KADSR2 ... H40		1.5mm	
CODE	Width a mm	Kg ad/pc	pcs
KADSR2 405 15 HDG	50	1.28	1
KADSR2 407 15 HDG	75	1.50	1
KADSR2 410 15 HDG	100	1.72	1
KADSR2 412 15 HDG	125	1.94	1
KADSR2 415 15 HDG	150	2.16	1
KADSR2 420 15 HDG	200	2.60	1
KADSR2 422 15 HDG	225	2.82	1
KADSR2 425 15 HDG	250	3.04	1
KADSR2 430 15 HDG	300	3.48	1
KADSR2 440 15 HDG	400	4.37	1
KADSR2 445 15 HDG	450	4.81	1
KADSR2 450 15 HDG	500	5.25	1
KADSR2 460 15 HDG	600	6.13	1
KADSR2 470 15 HDG	700	7.02	1
KADSR2 475 15 HDG	750	7.46	1
KADSR2 480 15 HDG	800	7.90	1
KADSR2 490 15 HDG	900	8.78	1
KADSR2 400 15 HDG	1000	9.67	1

Important!

To install vertical bend - use 4 pieces of KBE con. and 8 sets of CFS bolts and nuts (M6 or M8).

KADSR2 ... H40		2.0mm	
CODE	Width a mm	Kg ad/pc	pcs
KADSR2 405 20 HDG	50	1.68	1
KADSR2 407 20 HDG	75	1.97	1
KADSR2 410 20 HDG	100	2.27	1
KADSR2 412 20 HDG	125	2.56	1
KADSR2 415 20 HDG	150	2.85	1
KADSR2 420 20 HDG	200	3.44	1
KADSR2 422 20 HDG	225	3.74	1
KADSR2 425 20 HDG	250	4.03	1
KADSR2 430 20 HDG	300	4.62	1
KADSR2 440 20 HDG	400	5.80	1
KADSR2 445 20 HDG	450	6.39	1
KADSR2 450 20 HDG	500	6.98	1
KADSR2 460 20 HDG	600	8.15	1
KADSR2 470 20 HDG	700	9.33	1
KADSR2 475 20 HDG	750	9.92	1
KADSR2 480 20 HDG	800	10.51	1
KADSR2 490 20 HDG	900	11.69	1
KADSR2 400 20 HDG	1000	12.86	1

Vertical 90° Outside Bend of Cable Tray (Stable) Radius:600

90° Dikey Kanal Dış Bükey Elemanı (Sabit) Radyus:600 - Арка фиксированная, внешняя 90° радиус:600



Hot-Dip Galvanized

KADSR4 ... H40		1.5mm	
CODE	Width a mm	Kg ad/pc	pcs
KADSR4 405 15 HDG	50	2.04	1
KADSR4 407 15 HDG	75	2.39	1
KADSR4 410 15 HDG	100	2.75	1
KADSR4 412 15 HDG	125	3.10	1
KADSR4 415 15 HDG	150	3.45	1
KADSR4 420 15 HDG	200	4.16	1
KADSR4 422 15 HDG	225	4.51	1
KADSR4 425 15 HDG	250	4.87	1
KADSR4 430 15 HDG	300	5.57	1
KADSR4 440 15 HDG	400	6.99	1
KADSR4 445 15 HDG	450	7.69	1
KADSR4 450 15 HDG	500	8.40	1
KADSR4 460 15 HDG	600	9.81	1
KADSR4 470 15 HDG	700	11.22	1
KADSR4 475 15 HDG	750	11.93	1
KADSR4 480 15 HDG	800	12.64	1
KADSR4 490 15 HDG	900	14.05	1
KADSR4 400 15 HDG	1000	15.46	1

Important!

To install vertical bend - use 4 pieces of KBE con. and 8 sets of CFS bolts and nuts (M6 or M8).

KADSR4 ... H40		2.0mm	
CODE	Width a mm	Kg ad/pc	pcs
KADSR4 405 20 HDG	50	2.68	1
KADSR4 407 20 HDG	75	3.15	1
KADSR4 410 20 HDG	100	3.62	1
KADSR4 412 20 HDG	125	4.09	1
KADSR4 415 20 HDG	150	4.56	1
KADSR4 420 20 HDG	200	5.51	1
KADSR4 422 20 HDG	225	5.98	1
KADSR4 425 20 HDG	250	6.45	1
KADSR4 430 20 HDG	300	7.39	1
KADSR4 440 20 HDG	400	9.27	1
KADSR4 445 20 HDG	450	10.22	1
KADSR4 450 20 HDG	500	11.16	1
KADSR4 460 20 HDG	600	13.04	1
KADSR4 470 20 HDG	700	14.93	1
KADSR4 475 20 HDG	750	15.87	1
KADSR4 480 20 HDG	800	16.81	1
KADSR4 490 20 HDG	900	18.69	1
KADSR4 400 20 HDG	1000	20.58	1

KADSR2 H40 HDG

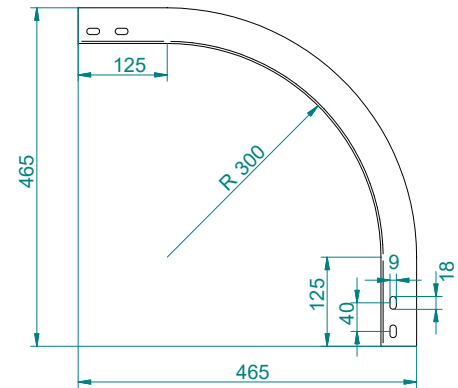
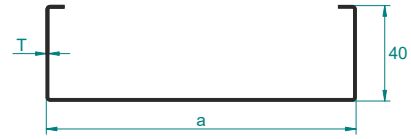

KADSR4 H40 HDG

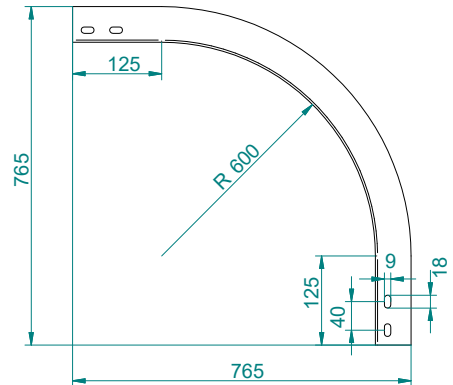
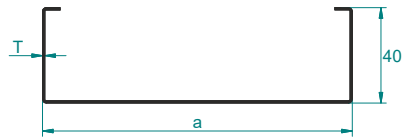

APPLICATIONS

Cable routing

MATERIAL

HDG-steel, hot-dip galv. to TS-EN ISO 1461:2011 (HDG)

Available finishes:

- Steel, strip-galv. acc. to the Sendzimir method to TS-EN 10346:2011 (PG)
- SS- stainless steel AISI 304L and AISI 316L (SS)
- EP- powder coating in a full range of colours (RAL)

Thickn. (ga) [mm]: **1.5 2.0**

Cable Trays - System of Side Height H40

Vertical 45° Outside Bend of Cable Tray (Stable)

45° Dikely Kanal Dış Bükey Elemanı (Sabit) - Арка фиксированная, внешняя 45°



Important!

To install vertical bend - use 4 pieces of KBE con. and 8 sets of CFS bolts and nuts (M6 or M8).

Hot-Dip Galvanized

KADS45 ... H40		1.5mm	
CODE	Width a mm	kg ad/pc	pcs
KADS45 405 15 HDG	50	0.55	1
KADS45 407 15 HDG	75	0.64	1
KADS45 410 15 HDG	100	0.74	1
KADS45 412 15 HDG	125	0.84	1
KADS45 415 15 HDG	150	0.92	1
KADS45 420 15 HDG	200	1.12	1
KADS45 422 15 HDG	225	1.21	1
KADS45 425 15 HDG	250	1.31	1
KADS45 430 15 HDG	300	1.49	1
KADS45 440 15 HDG	400	1.87	1
KADS45 445 15 HDG	450	2.06	1
KADS45 450 15 HDG	500	2.24	1
KADS45 460 15 HDG	600	2.62	1
KADS45 470 15 HDG	700	3.00	1
KADS45 475 15 HDG	750	3.19	1
KADS45 480 15 HDG	800	3.38	1
KADS45 490 15 HDG	900	3.76	1
KADS45 400 15 HDG	1000	4.13	1

KADS45 ... H40		2.0mm	
CODE	Width a mm	kg ad/pc	pcs
KADS45 405 20 HDG	50	0.72	1
KADS45 407 20 HDG	75	0.84	1
KADS45 410 20 HDG	100	0.97	1
KADS45 412 20 HDG	125	1.10	1
KADS45 415 20 HDG	150	1.22	1
KADS45 420 20 HDG	200	1.48	1
KADS45 422 20 HDG	225	1.60	1
KADS45 425 20 HDG	250	1.72	1
KADS45 430 20 HDG	300	1.98	1
KADS45 440 20 HDG	400	2.48	1
KADS45 445 20 HDG	450	2.73	1
KADS45 450 20 HDG	500	2.98	1
KADS45 460 20 HDG	600	3.48	1
KADS45 470 20 HDG	700	3.99	1
KADS45 475 20 HDG	750	4.24	1
KADS45 480 20 HDG	800	4.49	1
KADS45 490 20 HDG	900	4.99	1
KADS45 400 20 HDG	1000	5.49	1

Vertical 45° Inside Bend of Cable Tray (Stable)

45° Dikely Kanal İç Bükey Elemanı (Sabit) - Арка фиксированная, внутренняя 45°



Important!

To install vertical bend - use 4 pieces of KBE con. and 8 sets of CFS bolts and nuts (M6 or M8).

Hot-Dip Galvanized

KAIS45 ... H40		1.5mm	
CODE	Width a mm	kg ad/pc	pcs
KAIS45 405 15 HDG	50	0.55	1
KAIS45 407 15 HDG	75	0.64	1
KAIS45 410 15 HDG	100	0.74	1
KAIS45 412 15 HDG	125	0.84	1
KAIS45 415 15 HDG	150	0.92	1
KAIS45 420 15 HDG	200	1.12	1
KAIS45 422 15 HDG	225	1.21	1
KAIS45 425 15 HDG	250	1.31	1
KAIS45 430 15 HDG	300	1.49	1
KAIS45 440 15 HDG	400	1.87	1
KAIS45 445 15 HDG	450	2.06	1
KAIS45 450 15 HDG	500	2.24	1
KAIS45 460 15 HDG	600	2.62	1
KAIS45 470 15 HDG	700	3.00	1
KAIS45 475 15 HDG	750	3.19	1
KAIS45 480 15 HDG	800	3.38	1
KAIS45 490 15 HDG	900	3.76	1
KAIS45 400 15 HDG	1000	4.13	1

KAIS45 ... H40		2.0mm	
CODE	Width a mm	kg ad/pc	pcs
KAIS45 405 20 HDG	50	0.72	1
KAIS45 407 20 HDG	75	0.84	1
KAIS45 410 20 HDG	100	0.97	1
KAIS45 412 20 HDG	125	1.10	1
KAIS45 415 20 HDG	150	1.22	1
KAIS45 420 20 HDG	200	1.48	1
KAIS45 422 20 HDG	225	1.60	1
KAIS45 425 20 HDG	250	1.72	1
KAIS45 430 20 HDG	300	1.98	1
KAIS45 440 20 HDG	400	2.48	1
KAIS45 445 20 HDG	450	2.73	1
KAIS45 450 20 HDG	500	2.98	1
KAIS45 460 20 HDG	600	3.48	1
KAIS45 470 20 HDG	700	3.99	1
KAIS45 475 20 HDG	750	4.24	1
KAIS45 480 20 HDG	800	4.49	1
KAIS45 490 20 HDG	900	4.99	1
KAIS45 400 20 HDG	1000	5.49	1

KADS45 H40 HDG

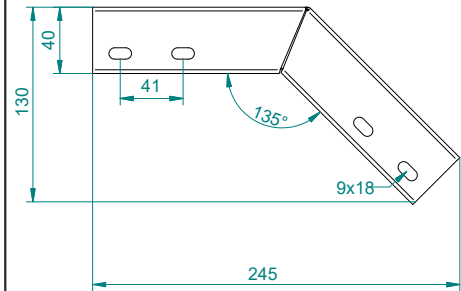
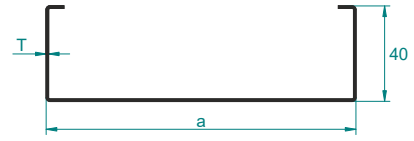

KAIS45 H40 HDG

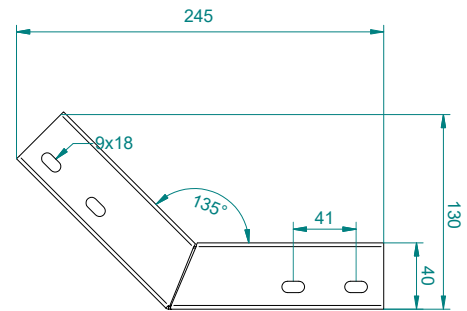
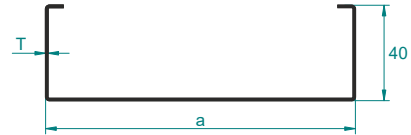

APPLICATIONS

Cable routing

MATERIAL

HDG-steel, hot-dip galv. to TS-EN ISO 1461:2011 (HDG)

Available finishes:

Steel, strip-galv. acc. to the Sendzimir method to TS-EN 10346:2011 (PG)
SS- stainless steel AISI 304L and AISI 316L (SS)
EP- powder coating in a full range of colours (RAL)

Thickn. (ga) [mm]: **1.5 2.0**

Cable Trays - System of Side Height H40

Vertical 45° Inside Bend of Cable Tray (Stable) Radius:300

45° Dikey Kanal İç Büküye Elemanı (Sabit) Radyus:300 - Арка фиксированная, внутренняя 45° радиус:300



Important!

To install vertical bend - use 4 pieces of KBE con. and 8 sets of CFS bolts and nuts (M6 or M8).

Hot-Dip Galvanized

KAIS45R2 ... H40		1.5mm	
CODE	Width a mm	Kg ad/pc	pcs
KAIS45R2 405 15 HDG	50	0.85	1
KAIS45R2 407 15 HDG	75	1.00	1
KAIS45R2 410 15 HDG	100	1.15	1
KAIS45R2 412 15 HDG	125	1.29	1
KAIS45R2 415 15 HDG	150	1.44	1
KAIS45R2 420 15 HDG	200	1.74	1
KAIS45R2 422 15 HDG	225	1.88	1
KAIS45R2 425 15 HDG	250	2.03	1
KAIS45R2 430 15 HDG	300	2.32	1
KAIS45R2 440 15 HDG	400	2.91	1
KAIS45R2 445 15 HDG	450	3.21	1
KAIS45R2 450 15 HDG	500	3.50	1
KAIS45R2 460 15 HDG	600	4.09	1
KAIS45R2 470 15 HDG	700	4.68	1
KAIS45R2 475 15 HDG	750	4.97	1
KAIS45R2 480 15 HDG	800	5.27	1
KAIS45R2 490 15 HDG	900	5.86	1
KAIS45R2 400 15 HDG	1000	6.45	1

KAIS45R2 ... H40		2.0mm	
CODE	Width a mm	Kg ad/pc	pcs
KAIS45R2 405 20 HDG	50	1.12	1
KAIS45R2 407 20 HDG	75	1.32	1
KAIS45R2 410 20 HDG	100	1.51	1
KAIS45R2 412 20 HDG	125	1.71	1
KAIS45R2 415 20 HDG	150	1.90	1
KAIS45R2 420 20 HDG	200	2.30	1
KAIS45R2 422 20 HDG	225	2.49	1
KAIS45R2 425 20 HDG	250	2.69	1
KAIS45R2 430 20 HDG	300	3.08	1
KAIS45R2 440 20 HDG	400	3.87	1
KAIS45R2 445 20 HDG	450	4.26	1
KAIS45R2 450 20 HDG	500	4.65	1
KAIS45R2 460 20 HDG	600	5.44	1
KAIS45R2 470 20 HDG	700	6.22	1
KAIS45R2 475 20 HDG	750	6.61	1
KAIS45R2 480 20 HDG	800	7.01	1
KAIS45R2 490 20 HDG	900	7.79	1
KAIS45R2 400 20 HDG	1000	8.58	1

Vertical 45° Inside Bend of Cable Tray (Stable) Radius:600

45° Dikey Kanal İç Büküye Elemanı (Sabit) Radyus:600 - Арка фиксированная, внутренняя 45° радиус:600



Important!

To install vertical bend - use 4 pieces of KBE con. and 8 sets of CFS bolts and nuts (M6 or M8).

Hot-Dip Galvanized

KAIS45R4 ... H40		1.5mm	
CODE	Width a mm	Kg ad/pc	pcs
KAIS45R4 405 15 HDG	50	1.28	1
KAIS45R4 407 15 HDG	75	1.50	1
KAIS45R4 410 15 HDG	100	1.72	1
KAIS45R4 412 15 HDG	125	1.94	1
KAIS45R4 415 15 HDG	150	2.16	1
KAIS45R4 420 15 HDG	200	2.60	1
KAIS45R4 422 15 HDG	225	2.82	1
KAIS45R4 425 15 HDG	250	3.04	1
KAIS45R4 430 15 HDG	300	3.48	1
KAIS45R4 440 15 HDG	400	4.37	1
KAIS45R4 445 15 HDG	450	4.81	1
KAIS45R4 450 15 HDG	500	5.25	1
KAIS45R4 460 15 HDG	600	6.13	1
KAIS45R4 470 15 HDG	700	7.02	1
KAIS45R4 475 15 HDG	750	7.46	1
KAIS45R4 480 15 HDG	800	7.90	1
KAIS45R4 490 15 HDG	900	8.78	1
KAIS45R4 400 15 HDG	1000	9.67	1

KAIS45R4 ... H40		2.0mm	
CODE	Width a mm	Kg ad/pc	pcs
KAIS45R4 405 20 HDG	50	1.68	1
KAIS45R4 407 20 HDG	75	1.97	1
KAIS45R4 410 20 HDG	100	2.27	1
KAIS45R4 412 20 HDG	125	2.56	1
KAIS45R4 415 20 HDG	150	2.85	1
KAIS45R4 420 20 HDG	200	3.44	1
KAIS45R4 422 20 HDG	225	3.74	1
KAIS45R4 425 20 HDG	250	4.03	1
KAIS45R4 430 20 HDG	300	4.62	1
KAIS45R4 440 20 HDG	400	5.80	1
KAIS45R4 445 20 HDG	450	6.39	1
KAIS45R4 450 20 HDG	500	6.98	1
KAIS45R4 460 20 HDG	600	8.15	1
KAIS45R4 470 20 HDG	700	9.33	1
KAIS45R4 475 20 HDG	750	9.92	1
KAIS45R4 480 20 HDG	800	10.51	1
KAIS45R4 490 20 HDG	900	11.69	1
KAIS45R4 400 20 HDG	1000	12.86	1

KAIS45R2 H40 HDG

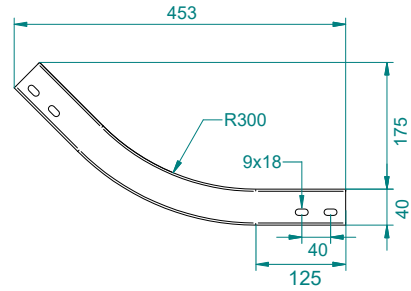
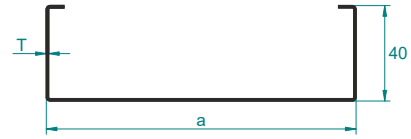

KAIS45R4 H40 HDG

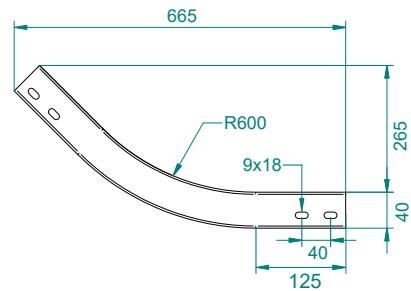
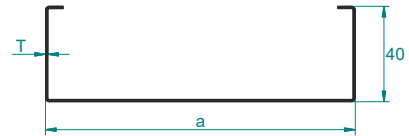

APPLICATIONS

Cable routing

MATERIAL

HDG-steel, hot-dip galv. to TS-EN ISO 1461:2011 (HDG)

Available finishes:

Steel, strip-galv. acc. to the Sendzimir method to TS-EN 10346:2011 (PG)
SS- stainless steel AISI 304L and AISI 316L (SS)
EP- powder coating in a full range of colours (RAL)

Thickn. (ga) [mm]: 1.5 2.0

Cable Trays - System of Side Height H40

Vertical 45° Outside Bend of Cable Tray (stable) Radius:300

45° Dikey Kanal Dış Bükey Elemanı (Sabit) Radyus:300 - Арка фиксированная, внешняя 45° радиус:300



Important!

To install vertical bend - use 4 pieces of KBE con. and 8 sets of CFS bolts and nuts (M6 or M8).

Hot-Dip Galvanized

KADS45R2 ... H40				KADS45R2 ... H40			
1.5mm				2.0mm			
CODE	Width a mm	kg ad/pc	pcs	CODE	Width a mm	kg ad/pc	pcs
KADS45R2 405 15 HDG	50	2.57	1	KADS45R2 405 20 HDG	50	2.75	1
KADS45R2 407 15 HDG	75	2.81	1	KADS45R2 407 20 HDG	75	2.99	1
KADS45R2 410 15 HDG	100	3.03	1	KADS45R2 410 20 HDG	100	3.21	1
KADS45R2 412 15 HDG	125	3.24	1	KADS45R2 412 20 HDG	125	3.42	1
KADS45R2 415 15 HDG	150	3.42	1	KADS45R2 415 20 HDG	150	3.60	1
KADS45R2 420 15 HDG	200	3.70	1	KADS45R2 420 20 HDG	200	3.88	1
KADS45R2 422 15 HDG	225	3.90	1	KADS45R2 422 20 HDG	225	4.08	1
KADS45R2 425 15 HDG	250	3.99	1	KADS45R2 425 20 HDG	250	4.17	1
KADS45R2 430 15 HDG	300	4.19	1	KADS45R2 430 20 HDG	300	4.37	1
KADS45R2 440 15 HDG	400	4.62	1	KADS45R2 440 20 HDG	400	4.80	1
KADS45R2 445 15 HDG	450	4.93	1	KADS45R2 445 20 HDG	450	5.11	1
KADS45R2 450 15 HDG	500	5.15	1	KADS45R2 450 20 HDG	500	5.33	1
KADS45R2 460 15 HDG	600	5.53	1	KADS45R2 460 20 HDG	600	5.71	1
KADS45R2 470 15 HDG	700	5.92	1	KADS45R2 470 20 HDG	700	6.10	1
KADS45R2 475 15 HDG	750	6.04	1	KADS45R2 475 20 HDG	750	6.22	1
KADS45R2 480 15 HDG	800	6.30	1	KADS45R2 480 20 HDG	800	6.48	1
KADS45R2 490 15 HDG	900	6.67	1	KADS45R2 490 20 HDG	900	6.85	1
KADS45R2 400 15 HDG	1000	7.04	1	KADS45R2 400 20 HDG	1000	7.22	1

Vertical 45° Outside Bend of Cable Tray (stable) Radius:600

45° Dikey Kanal Dış Bükey Elemanı (Sabit) Radyus:600 - Арка фиксированная, внешняя 45° радиус:600



Important!

To install vertical bend - use 4 pieces of KBE con. and 8 sets of CFS bolts and nuts (M6 or M8).

Hot-Dip Galvanized

KADS45R4 ... H40				KADS45R4 ... H40			
1.5mm				2.0mm			
CODE	Width a mm	kg ad/pc	pcs	CODE	Width a mm	kg ad/pc	pcs
KADS45R4 405 15 HDG	50	2.72	1	KADS45R4 405 20 HDG	50	2.93	1
KADS45R4 407 15 HDG	75	2.96	1	KADS45R4 407 20 HDG	75	3.17	1
KADS45R4 410 15 HDG	100	3.18	1	KADS45R4 410 20 HDG	100	3.39	1
KADS45R4 412 15 HDG	125	3.39	1	KADS45R4 412 20 HDG	125	3.60	1
KADS45R4 415 15 HDG	150	3.57	1	KADS45R4 415 20 HDG	150	3.78	1
KADS45R4 420 15 HDG	200	3.85	1	KADS45R4 420 20 HDG	200	4.06	1
KADS45R4 422 15 HDG	225	4.05	1	KADS45R4 422 20 HDG	225	4.26	1
KADS45R4 425 15 HDG	250	4.14	1	KADS45R4 425 20 HDG	250	4.35	1
KADS45R4 430 15 HDG	300	4.34	1	KADS45R4 430 20 HDG	300	4.55	1
KADS45R4 440 15 HDG	400	4.77	1	KADS45R4 440 20 HDG	400	4.98	1
KADS45R4 445 15 HDG	450	5.08	1	KADS45R4 445 20 HDG	450	5.29	1
KADS45R4 450 15 HDG	500	5.30	1	KADS45R4 450 20 HDG	500	5.51	1
KADS45R4 460 15 HDG	600	5.68	1	KADS45R4 460 20 HDG	600	5.89	1
KADS45R4 470 15 HDG	700	6.07	1	KADS45R4 470 20 HDG	700	6.28	1
KADS45R4 475 15 HDG	750	6.18	1	KADS45R4 475 20 HDG	750	6.40	1
KADS45R4 480 15 HDG	800	6.45	1	KADS45R4 480 20 HDG	800	6.66	1
KADS45R4 490 15 HDG	900	6.82	1	KADS45R4 490 20 HDG	900	7.03	1
KADS45R4 400 15 HDG	1000	7.19	1	KADS45R4 400 20 HDG	1000	7.40	1

KADS45R2 H40 HDG

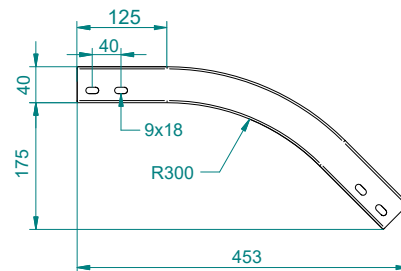
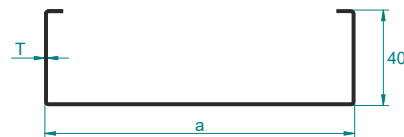

KADS45R4 H40 HDG

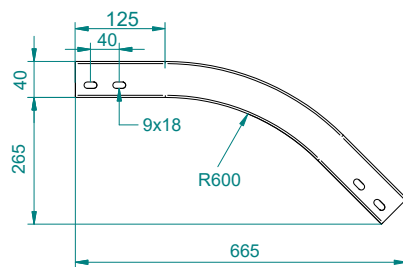
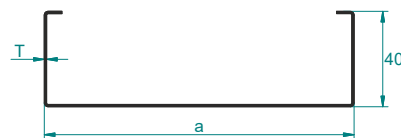

APPLICATIONS

Cable routing

MATERIAL

HDG-steel, hot-dip galv. to TS-EN ISO 1461:2011 (HDG)

Available finishes:

Steel, strip-galv. acc. to the Sendzimir method to TS-EN 10346:2011 (PG)
SS- stainless steel AISI 304L and AISI 316L (SS)
EP- powder coating in a full range of colours (RAL)

Thickn. (ga) [mm]: **1.5 2.0**

Cable Trays - System of Side Height H40

Modular Inside - Outside Bends

Modüler İç-Dış Büküye - Шарнирная дуга



Important!

To install cable tray - bend use Screw Sets CFS M6 or CFS M8

Hot-Dip Galvanized

KAMD ... H40				KAMD ... H40			
1.5mm				2.0mm			
CODE	Width a mm	kg ad/pc	pcs	CODE	Width a mm	kg ad/pc	pcs
KAMD 405 15 HDG	50	1.24	1	KAMD 405 20 HDG	50	1.52	1
KAMD 407 15 HDG	75	1.32	1	KAMD 407 20 HDG	75	1.64	1
KAMD 410 15 HDG	100	1.40	1	KAMD 410 20 HDG	100	1.75	1
KAMD 412 15 HDG	125	1.49	1	KAMD 412 20 HDG	125	1.86	1
KAMD 415 15 HDG	150	1.57	1	KAMD 415 20 HDG	150	1.97	1
KAMD 420 15 HDG	200	1.73	1	KAMD 420 20 HDG	200	2.20	1
KAMD 422 15 HDG	225	1.83	1	KAMD 422 20 HDG	225	2.31	1
KAMD 425 15 HDG	250	1.91	1	KAMD 425 20 HDG	250	2.42	1
KAMD 430 15 HDG	300	2.08	1	KAMD 430 20 HDG	300	2.66	1
KAMD 440 15 HDG	400	2.42	1	KAMD 440 20 HDG	400	3.11	1
KAMD 445 15 HDG	450	2.58	1	KAMD 445 20 HDG	450	3.33	1
KAMD 450 15 HDG	500	2.76	1	KAMD 450 20 HDG	500	3.56	1
KAMD 460 15 HDG	600	3.09	1	KAMD 460 20 HDG	600	4.00	1
KAMD 470 15 HDG	700	3.43	1	KAMD 470 20 HDG	700	4.47	1
KAMD 475 15 HDG	750	3.60	1	KAMD 475 20 HDG	750	4.69	1
KAMD 480 15 HDG	800	3.78	1	KAMD 480 20 HDG	800	4.92	1
KAMD 490 15 HDG	900	4.12	1	KAMD 490 20 HDG	900	5.36	1
KAMD 400 15 HDG	1000	4.45	1	KAMD 400 20 HDG	1000	5.81	1

KAMD H40 HDG

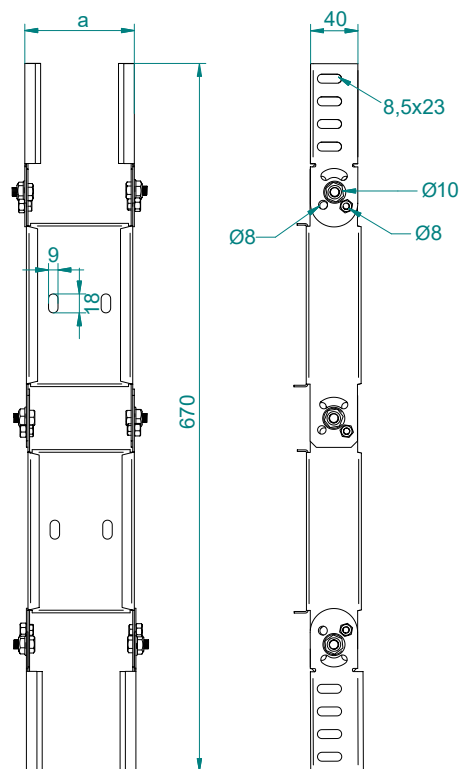

Modular Adjustable Riser Bend

Modüler İniş - Çıkış Elemanı - Шарнирный элемент дуги



Important!

To install cable tray - bend use Screw Sets CFS M6 or CFS M8

Hot-Dip Galvanized

KAMB ... H40				KAMB ... H40			
1.5mm				2.0mm			
CODE	Width a mm	kg ad/pc	pcs	CODE	Width a mm	kg ad/pc	pcs
KAMB 405 15 HDG	50	0.35	1	KAMB 405 20 HDG	50	0.45	1
KAMB 407 15 HDG	75	0.40	1	KAMB 407 20 HDG	75	0.53	1
KAMB 410 15 HDG	100	0.47	1	KAMB 410 20 HDG	100	0.61	1
KAMB 412 15 HDG	125	0.52	1	KAMB 412 20 HDG	125	0.69	1
KAMB 415 15 HDG	150	0.58	1	KAMB 415 20 HDG	150	0.76	1
KAMB 420 15 HDG	200	0.70	1	KAMB 420 20 HDG	200	0.92	1
KAMB 422 15 HDG	225	0.76	1	KAMB 422 20 HDG	225	1.00	1
KAMB 425 15 HDG	250	0.82	1	KAMB 425 20 HDG	250	1.08	1
KAMB 430 15 HDG	300	0.93	1	KAMB 430 20 HDG	300	1.24	1
KAMB 440 15 HDG	400	1.17	1	KAMB 440 20 HDG	400	1.56	1
KAMB 445 15 HDG	450	1.29	1	KAMB 445 20 HDG	450	1.71	1
KAMB 450 15 HDG	500	1.40	1	KAMB 450 20 HDG	500	1.87	1
KAMB 460 15 HDG	600	1.64	1	KAMB 460 20 HDG	600	2.18	1
KAMB 470 15 HDG	700	1.88	1	KAMB 470 20 HDG	700	2.49	1
KAMB 475 15 HDG	750	2.00	1	KAMB 475 20 HDG	750	2.65	1
KAMB 480 15 HDG	800	2.12	1	KAMB 480 20 HDG	800	2.81	1
KAMB 490 15 HDG	900	2.35	1	KAMB 490 20 HDG	900	3.12	1
KAMB 400 15 HDG	1000	2.59	1	KAMB 400 20 HDG	1000	3.44	1

KAMB H40 HDG

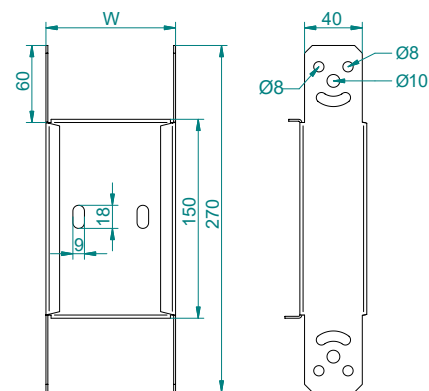

APPLICATIONS

Cable routing

MATERIAL

HDG-steel, hot-dip galv. to TS-EN ISO 1461:2011 (HDG)

Available finishes:

Steel, strip-galv. acc. to the Sendzimir method

to TS-EN 10346:2011 (PG)

SS- stainless steel AISI 304L and AISI 316L (SS)

EP- powder coating in a full range of colours (RAL)

Thickn. (ga) [mm]: **1.5 2.0**

KAMD / Modular Outside - Inside Bends Mounting

Modüler İç-Dış Bükme Montaj - Шарнирная дуга

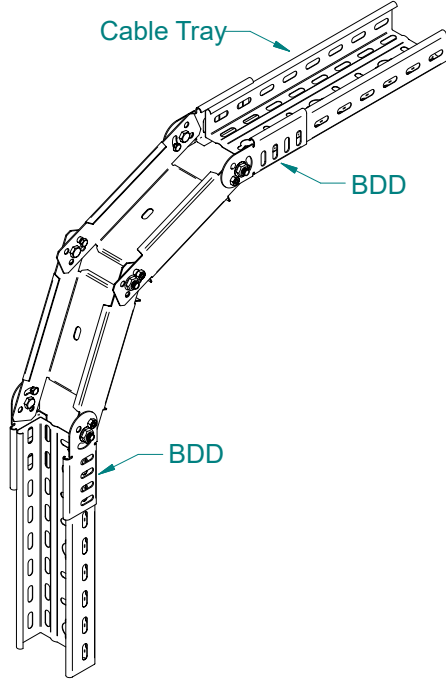

Outside Bend

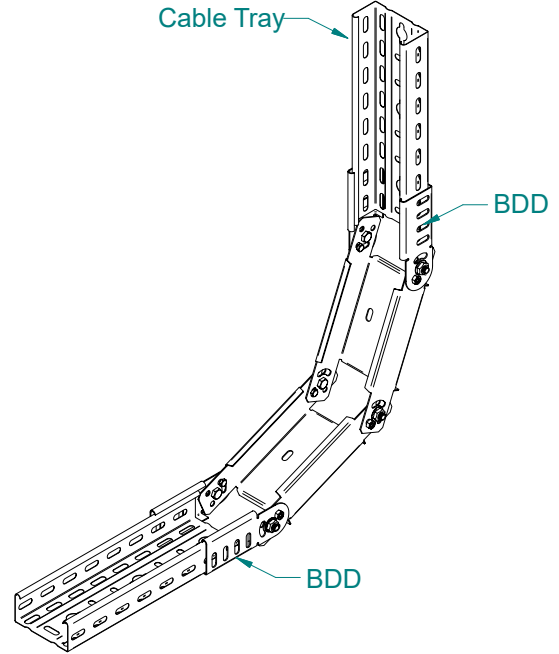

Inside Bend

KAMB / Modular Adjustable Riser Bend

Modüler İniş - Çıkış Elemanı - Шарнирный элемент дуги

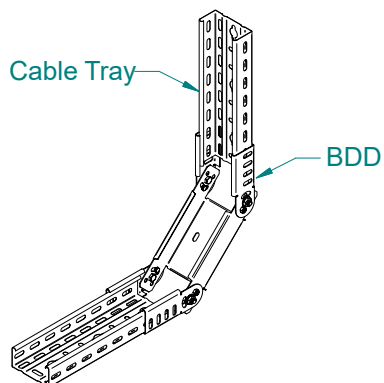
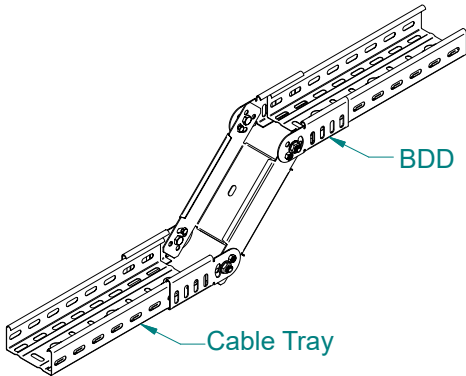

KAMB Modular Systems for more Radius

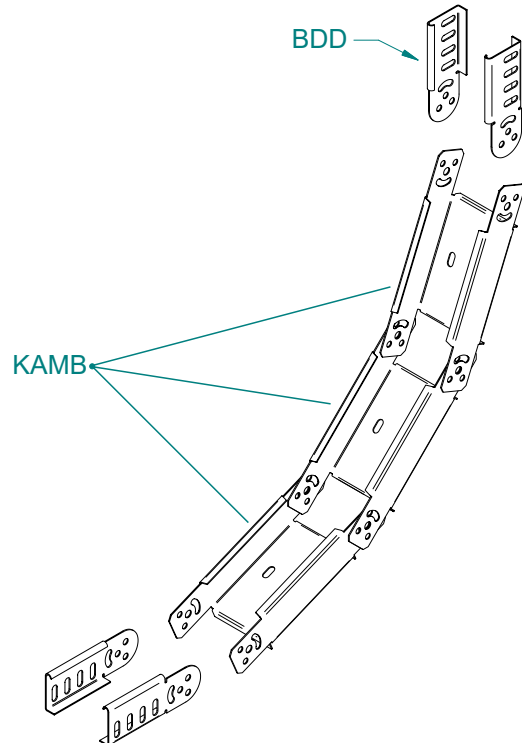

Cable Trays - System of Side Height H40

Vertical Tee - Lengthwise

Dikey T Dönlüş - Вертикальчик тройник, развернутый



Hot-Dip Galvanized

Important!
To install cable tray - bend use Screw Sets
CFS M6 or CFS M8

KADT ... H40		1.5mm	
CODE	Width a mm	KG ad/pc	pcs
KADT 410 15 HDG	100	1.49	1
KADT 412 15 HDG	125	1.76	1
KADT 415 15 HDG	150	2.04	1
KADT 420 15 HDG	200	2.64	1
KADT 422 15 HDG	225	2.97	1
KADT 425 15 HDG	250	3.31	1
KADT 430 15 HDG	300	4.03	1
KADT 440 15 HDG	400	5.66	1
KADT 445 15 HDG	450	6.56	1
KADT 450 15 HDG	500	7.52	1
KADT 460 15 HDG	600	9.61	1
KADT 470 15 HDG	700	11.94	1
KADT 475 15 HDG	750	13.20	1
KADT 480 15 HDG	800	14.51	1
KADT 490 15 HDG	900	17.31	1
KADT 400 15 HDG	1000	20.35	1

KADT ... H40		2.0mm	
CODE	Width a mm	KG ad/pc	pcs
KADT 410 20 HDG	100	1.98	1
KADT 412 20 HDG	125	2.34	1
KADT 415 20 HDG	150	2.71	1
KADT 420 20 HDG	200	3.52	1
KADT 422 20 HDG	225	3.96	1
KADT 425 20 HDG	250	4.41	1
KADT 430 20 HDG	300	5.37	1
KADT 440 20 HDG	400	7.54	1
KADT 445 20 HDG	450	8.74	1
KADT 450 20 HDG	500	10.02	1
KADT 460 20 HDG	600	12.82	1
KADT 470 20 HDG	700	15.92	1
KADT 475 20 HDG	750	17.60	1
KADT 480 20 HDG	800	19.35	1
KADT 490 20 HDG	900	23.08	1
KADT 400 20 HDG	1000	27.13	1

Vertical Tee from the Middle

Dikey Ortadan T dönlüş - Вертикальчик тройник, симметричный

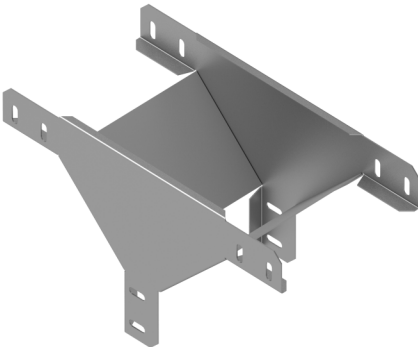

Hot-Dip Galvanized

Important!
To install cable tray - bend use Screw Sets
CFS M6 or CFS M8

KAMT ... H40		1.5mm	
CODE	Width a mm	KG ad/pc	pcs
KAMT 410 15 HDG	100	1.14	1
KAMT 412 15 HDG	125	1.22	1
KAMT 415 15 HDG	150	1.30	1
KAMT 420 15 HDG	200	1.47	1
KAMT 422 15 HDG	225	1.55	1
KAMT 425 15 HDG	250	1.63	1
KAMT 430 15 HDG	300	1.79	1
KAMT 440 15 HDG	400	3.53	1
KAMT 445 15 HDG	450	3.83	1
KAMT 450 15 HDG	500	4.12	1
KAMT 460 15 HDG	600	4.71	1
KAMT 470 15 HDG	700	6.53	1
KAMT 475 15 HDG	750	6.88	1
KAMT 480 15 HDG	800	7.23	1
KAMT 490 15 HDG	900	7.94	1
KAMT 400 15 HDG	1000	8.65	1

KAMT ... H40		2.0mm	
CODE	Width a mm	KG ad/pc	pcs
KAMT 410 20 HDG	100	1.51	1
KAMT 412 20 HDG	125	1.62	1
KAMT 415 20 HDG	150	1.73	1
KAMT 420 20 HDG	200	1.95	1
KAMT 422 20 HDG	225	2.06	1
KAMT 425 20 HDG	250	2.17	1
KAMT 430 20 HDG	300	2.39	1
KAMT 440 20 HDG	400	4.71	1
KAMT 445 20 HDG	450	5.10	1
KAMT 450 20 HDG	500	5.49	1
KAMT 460 20 HDG	600	6.28	1
KAMT 470 20 HDG	700	8.70	1
KAMT 475 20 HDG	750	9.17	1
KAMT 480 20 HDG	800	9.64	1
KAMT 490 20 HDG	900	10.59	1
KAMT 400 20 HDG	1000	11.53	1

KADT H40 HDG

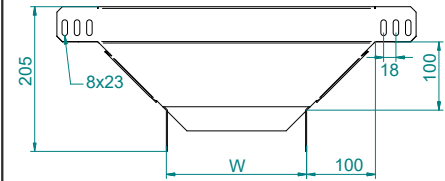
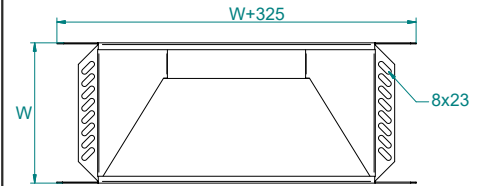

KAMT H40 HDG

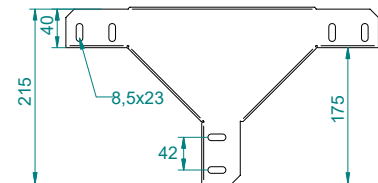
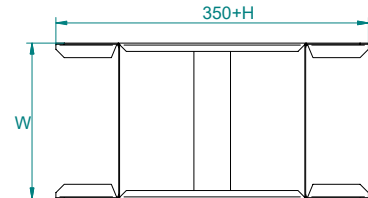

APPLICATIONS

Cable routing

MATERIAL

HDG-steel, hot-dip galv. to TS-EN ISO 1461:2011 (HDG)

Available finishes:

Steel, strip-galv. acc. to the Sendzimir method
to TS-EN 10346:2011 (PG)
SS- stainless steel AISI 304L and AISI 316L (SS)
EP- powder coating in a full range of colours (RAL)

Thickn. (ga) [mm]: 1.5 2.0

Cable Trays - System of Side Height H40

Vertical Elbow - Left

Dikey Sol Dirsek - Вертикальный левый угол



Hot-Dip Galvanized

Important!
To install cable tray - bend use Screw Sets
CFS M6 or CFS M8

KADL ... H40		1.5mm	
CODE	Width a mm	kg ad/pc	pcs
KADL 410 15 HDG	100	1.17	1
KADL 412 15 HDG	125	1.41	1
KADL 415 15 HDG	150	1.66	1
KADL 420 15 HDG	200	2.21	1
KADL 422 15 HDG	225	2.51	1
KADL 425 15 HDG	250	2.82	1
KADL 430 15 HDG	300	3.48	1
KADL 440 15 HDG	400	4.99	1
KADL 445 15 HDG	450	5.83	1
KADL 450 15 HDG	500	6.73	1
KADL 460 15 HDG	600	8.71	1
KADL 470 15 HDG	700	10.92	1
KADL 475 15 HDG	750	12.12	1
KADL 480 15 HDG	800	13.37	1
KADL 490 15 HDG	900	16.06	1
KADL 400 15 HDG	1000	18.98	1

KADL ... H40		2.0mm	
CODE	Width a mm	kg ad/pc	pcs
KADL 410 20 HDG	100	1.56	1
KADL 412 20 HDG	125	1.88	1
KADL 415 20 HDG	150	2.21	1
KADL 420 20 HDG	200	2.94	1
KADL 422 20 HDG	225	3.34	1
KADL 425 20 HDG	250	3.75	1
KADL 430 20 HDG	300	4.64	1
KADL 440 20 HDG	400	6.65	1
KADL 445 20 HDG	450	7.77	1
KADL 450 20 HDG	500	8.97	1
KADL 460 20 HDG	600	11.61	1
KADL 470 20 HDG	700	14.56	1
KADL 475 20 HDG	750	16.16	1
KADL 480 20 HDG	800	17.83	1
KADL 490 20 HDG	900	21.41	1
KADL 400 20 HDG	1000	25.30	1

Vertical Elbow - Right

Dikey Sağ Dirsek - Вертикальный правый угол



Hot-Dip Galvanized

Important!
To install cable tray - bend use Screw Sets
CFS M6 or CFS M8

KADG ... H40		1.5mm	
CODE	Width a mm	kg ad/pc	pcs
KADG 410 15 HDG	100	1.17	1
KADG 412 15 HDG	125	1.41	1
KADG 415 15 HDG	150	1.66	1
KADG 420 15 HDG	200	2.21	1
KADG 422 15 HDG	225	2.51	1
KADG 425 15 HDG	250	2.82	1
KADG 430 15 HDG	300	3.48	1
KADG 440 15 HDG	400	4.99	1
KADG 445 15 HDG	450	5.83	1
KADG 450 15 HDG	500	6.73	1
KADG 460 15 HDG	600	8.71	1
KADG 470 15 HDG	700	10.92	1
KADG 475 15 HDG	750	12.12	1
KADG 480 15 HDG	800	13.37	1
KADG 490 15 HDG	900	16.06	1
KADG 400 15 HDG	1000	18.98	1

KADG ... H40		2.0mm	
CODE	Width a mm	kg ad/pc	pcs
KADG 410 20 HDG	100	1.56	1
KADG 412 20 HDG	125	1.88	1
KADG 415 20 HDG	150	2.21	1
KADG 420 20 HDG	200	2.94	1
KADG 422 20 HDG	225	3.34	1
KADG 425 20 HDG	250	3.75	1
KADG 430 20 HDG	300	4.64	1
KADG 440 20 HDG	400	6.65	1
KADG 445 20 HDG	450	7.77	1
KADG 450 20 HDG	500	8.97	1
KADG 460 20 HDG	600	11.61	1
KADG 470 20 HDG	700	14.56	1
KADG 475 20 HDG	750	16.16	1
KADG 480 20 HDG	800	17.83	1
KADG 490 20 HDG	900	21.41	1
KADG 400 20 HDG	1000	25.30	1

KADL H40 HDG

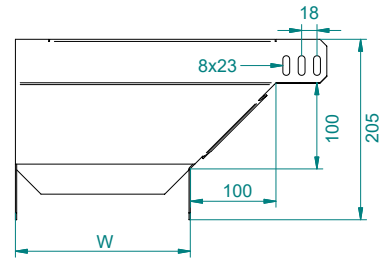
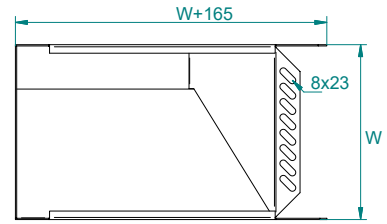

KADG H40 HDG

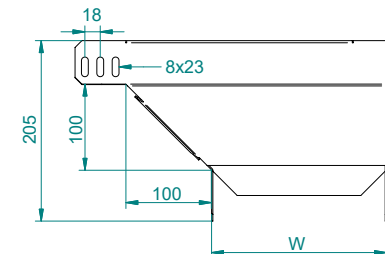
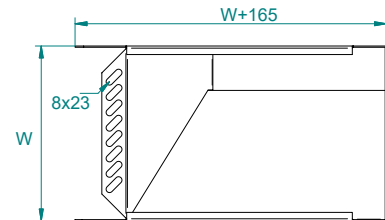

APPLICATIONS

Cable routing

MATERIAL

HDG-steel, hot-dip galv. to TS-EN ISO 1461:2011 (HDG)

Available finishes:

Steel, strip-galv. acc. to the Sendzimir method to TS-EN 10346:2011 (PG)
SS- stainless steel AISI 304L and AISI 316L (SS)
EP- powder coating in a full range of colours (RAL)

Thickn. (ga) [mm]: 1.5 2.0

Cable Trays - System of Side Height H40

Reducer Connector - Single Type

Redüksiyon - Редукционный переходник



Hot-Dip Galvanized

RT ... H40		1.5mm	
CODE	Length L mm	kg ad/pc	pcs
RT 40 25 15 HDG	25	0.08	1
RT 40 50 15 HDG	50	0.09	1
RT 40 75 15 HDG	75	0.10	1
RT 40 100 15 HDG	100	0.11	1
RT 40 125 15 HDG	125	0.12	1
RT 40 150 15 HDG	150	0.13	1
RT 40 175 15 HDG	175	0.14	1
RT 40 200 15 HDG	200	0.15	1
RT 40 225 15 HDG	225	0.16	1
RT 40 250 15 HDG	250	0.17	1
RT 40 275 15 HDG	275	0.19	1
RT 40 300 15 HDG	300	0.20	1
RT 40 325 15 HDG	325	0.21	1
RT 40 350 15 HDG	350	0.22	1
RT 40 375 15 HDG	375	0.23	1
RT 40 400 15 HDG	400	0.24	1
RT 40 425 15 HDG	425	0.25	1
RT 40 450 15 HDG	450	0.26	1
RT 40 475 15 HDG	475	0.27	1
RT 40 500 15 HDG	500	0.28	1
RT 40 525 15 HDG	525	0.29	1
RT 40 550 15 HDG	550	0.30	1
RT 40 575 15 HDG	575	0.31	1

Important!

To install cable tray - bend use Screw Sets
CFS M6 or CFS M8

RT ... H40		2.0mm	
CODE	Length L mm	kg ad/pc	pcs
RT 40 25 20 HDG	25	0.10	1
RT 40 50 20 HDG	50	0.12	1
RT 40 75 20 HDG	75	0.13	1
RT 40 100 20 HDG	100	0.15	1
RT 40 125 20 HDG	125	0.16	1
RT 40 150 20 HDG	150	0.17	1
RT 40 175 20 HDG	175	0.19	1
RT 40 200 20 HDG	200	0.20	1
RT 40 225 20 HDG	225	0.22	1
RT 40 250 20 HDG	250	0.23	1
RT 40 275 20 HDG	275	0.25	1
RT 40 300 20 HDG	300	0.26	1
RT 40 325 20 HDG	325	0.27	1
RT 40 350 20 HDG	350	0.29	1
RT 40 375 20 HDG	375	0.30	1
RT 40 400 20 HDG	400	0.32	1
RT 40 425 20 HDG	425	0.33	1
RT 40 450 20 HDG	450	0.34	1
RT 40 475 20 HDG	475	0.36	1
RT 40 500 20 HDG	500	0.37	1
RT 40 525 20 HDG	525	0.39	1
RT 40 550 20 HDG	550	0.40	1
RT 40 575 20 HDG	575	0.41	1

RT H40 HDG

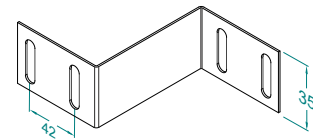
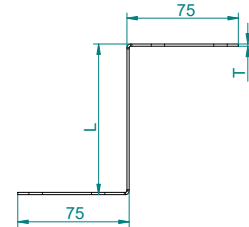

Stop End

Sonlandırma - Заглушка

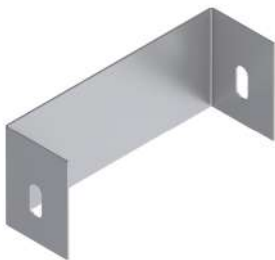

Hot-Dip Galvanized

SON ... H40		1.5mm	
CODE	Width a mm	kg ad/pc	pcs
SON 405 15 HDG	50	0.08	1
SON 407 15 HDG	75	0.09	1
SON 410 15 HDG	100	0.10	1
SON 412 15 HDG	125	0.11	1
SON 415 15 HDG	150	0.12	1
SON 420 15 HDG	200	0.14	1
SON 422 15 HDG	225	0.15	1
SON 425 15 HDG	250	0.16	1
SON 430 15 HDG	300	0.18	1
SON 440 15 HDG	400	0.23	1
SON 445 15 HDG	450	0.25	1
SON 450 15 HDG	500	0.27	1
SON 460 15 HDG	600	0.31	1
SON 470 15 HDG	700	0.35	1
SON 475 15 HDG	750	0.37	1
SON 480 15 HDG	800	0.39	1
SON 490 15 HDG	900	0.44	1
SON 400 15 HDG	1000	0.48	1

Important!

To install cable tray - bend use Screw Sets
CFS M6 or CFS M8

SON ... H40		2.0mm	
CODE	Width a mm	kg ad/pc	pcs
SON 405 20 HDG	50	0.10	1
SON 407 20 HDG	75	0.12	1
SON 410 20 HDG	100	0.13	1
SON 412 20 HDG	125	0.14	1
SON 415 20 HDG	150	0.16	1
SON 420 20 HDG	200	0.19	1
SON 422 20 HDG	225	0.20	1
SON 425 20 HDG	250	0.21	1
SON 430 20 HDG	300	0.24	1
SON 440 20 HDG	400	0.30	1
SON 445 20 HDG	450	0.33	1
SON 450 20 HDG	500	0.36	1
SON 460 20 HDG	600	0.41	1
SON 470 20 HDG	700	0.47	1
SON 475 20 HDG	750	0.50	1
SON 480 20 HDG	800	0.52	1
SON 490 20 HDG	900	0.58	1
SON 400 20 HDG	1000	0.64	1

SON H40 HDG

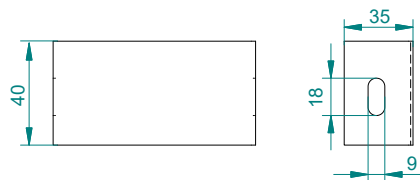
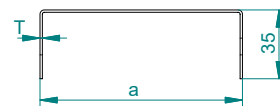

APPLICATIONS

Cable routing

MATERIAL

HDG-steel, hot-dip galv. to TS-EN ISO 1461:2011 (HDG)

Available finishes:

Steel, strip-galv. acc. to the Sendzimir method
to TS-EN 10346:2011 (PG)
SS- stainless steel AISI 304L and AISI 316L (SS)
EP- powder coating in a full range of colours (RAL)

Thickn. (ga) [mm]: 1.5 2.0

Cable Trays - System of Side Height H40

Adjustable Vertical Connector

Dikey Seviye Degistirme Eki - Шарнирный соединитель

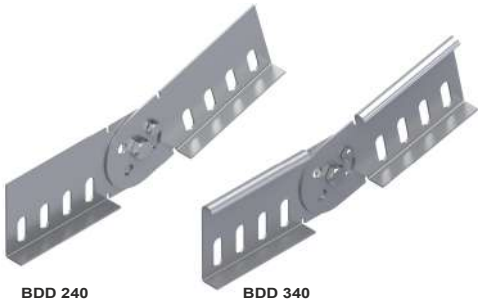

BDD 240

BDD 340

Important!
To install cable tray - bend use Screw Sets
CFS M6 or CFS M8

Hot-Dip Galvanized

BDD ... H40		1.5mm		
CODE	Length L mm	KG ad/pc	KG ad/pc	pcs
BDD 240 15 HDG	250	0.17		1
		2.0mm		
BDD 240 20 HDG	250	0.23		1

BDD ... H40		1.5mm		
CODE	Length L mm	KG ad/pc	KG ad/pc	pcs
BDD 340 15 HDG	250	0.20		1
		2.0mm		
BDD 340 20 HDG	250	0.27		1

Adjustable Horizontal Connector - Hinged Type

Menteşeli Yatay Seviye Degistirme Eki - Шарнирный угловой соединитель

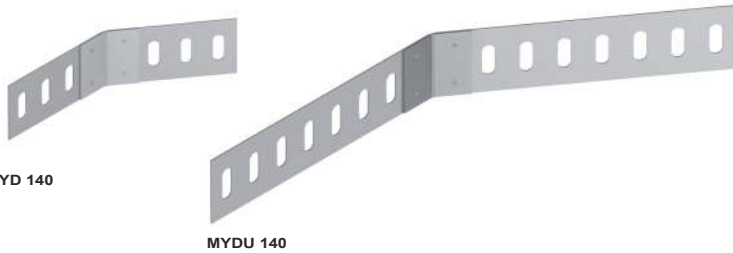

MYD 140

MYDU 140

Important!
To install cable tray - bend use Screw Sets
CFS M6 or CFS M8

Hot-Dip Galvanized

MYD ... H40		1.5mm		
CODE	Length L mm	KG ad/pc	KG ad/pc	pcs
MYD 140 15 HDG	175	0.12		1
		2.0mm		
MYD 140 20 HDG	175	0.16		1

MYDU ... H40		1.5mm		
CODE	Length L mm	KG ad/pc	KG ad/pc	pcs
MYDU 140 15 HDG	175	0.29		1
		2.0mm		
MYDU 140 20 HDG	175	0.38		1

Adjustable Horizontal Connector - Long Type

Yatay seviye degiştirme eki - Uzun - Угловой соединитель - длинный

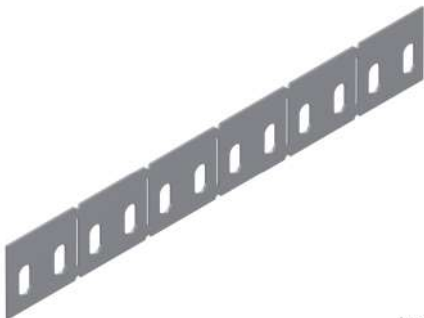

Pre - Galvanized

BYDU 1 ... H40		1.5mm		
CODE	Length L mm	KG 1m	KG 1m	pcs
BYDU 140 15 HDG	1000	0.39		1

Important!
To install cable tray - bend use Screw Sets
CFS M6 or CFS M8

BYDU 1 ... H40		2.0mm		
CODE	Length L mm	KG 1m	KG 1m	pcs
BYDU 140 20 HDG	1000	0.51		1

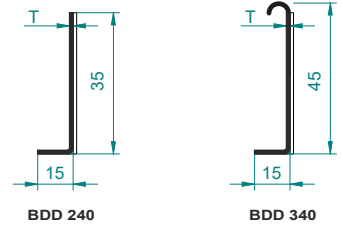

BDD 240

BDD 340

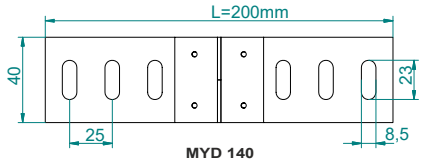
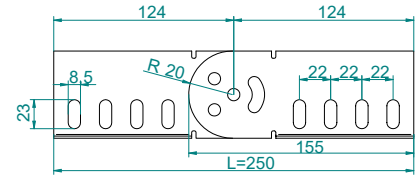

MYD 140

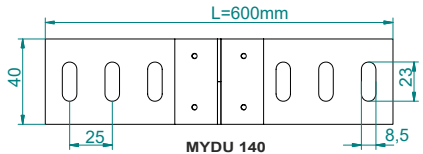

MYDU 140

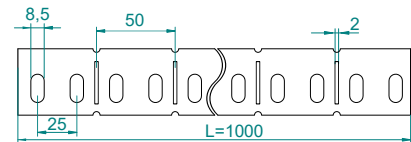

BYDU H40

APPLICATIONS

Cable routing

MATERIAL

HDG-steel, hot-dip galv. to TS-EN ISO 1461:2011 (HDG)

Available finishes:

Steel, strip-galv. acc. to the Sendzimir method
to TS-EN 10346:2011 (PG)
SS- stainless steel AISI 304L and AISI 316L (SS)
EP- powder coating in a full range of colours (RAL)

Thickn. (ga) [mm]: 1.5 2.0

Cable Trays - System of Side Height H40

Seperator

Seperatör - Перегородка

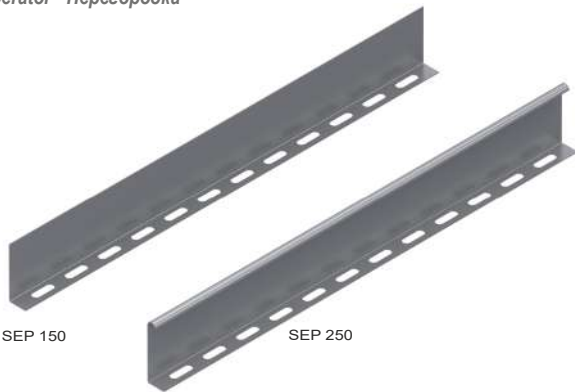

SEP 150

SEP 250

Hot-Dip Galvanized

SEP ... H40		1.0mm	
CODE	Length L mm	KG 1m	pcs
SEP 140 10 HDG	3000	0.48	1
SEP ... H40		1.5mm	
CODE	Length L mm	KG 1m	pcs
SEP 140 15 HDG	3000	0.71	1
SEP ... H40		2.0mm	
CODE	Length L mm	KG 1m	pcs
SEP 140 20 HDG	3000	0.95	1

Important!
To install cable tray - bend use Screw Sets CFS M6 or CFS M8

SEP ... H40		1.0mm	
CODE	Length L mm	KG 1m	pcs
SEP 240 10 HDG	3000	0.55	1
SEP ... H40		1.5mm	
CODE	Length L mm	KG 1m	pcs
SEP 240 15 HDG	3000	0.83	1
SEP ... H40		2.0mm	
CODE	Length L mm	KG 1m	pcs
SEP 240 20 HDG	3000	1.10	1

Seperator Horizontal Adjustable

Seperatör Yatay Ayarlanabilir - Перегородка шарнирная

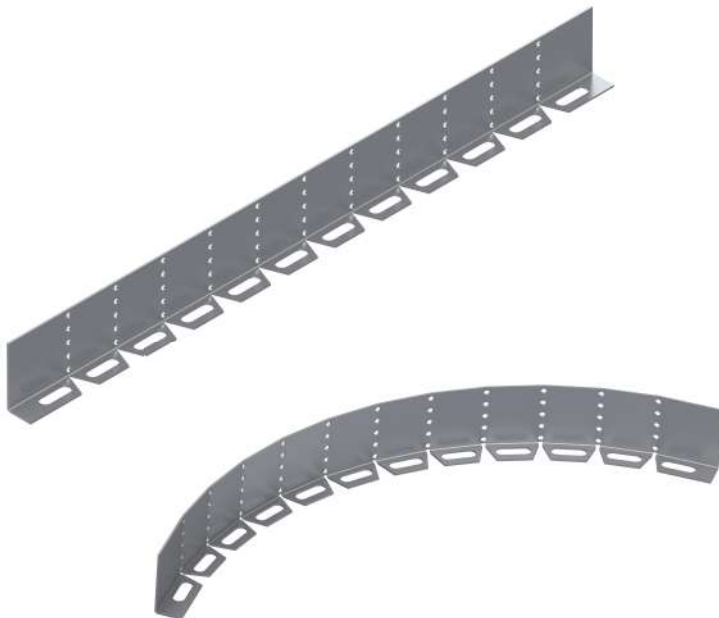

Hot-Dip Galvanized

SEP Y40 H40		1.5mm	
CODE	Length L mm	KG ad/pc	pcs
SEP Y40 15 HDG	1500	1.06	1

Important!
To install cable tray - bend use Screw Sets CFS M6 or CFS M8

SEP Y40 H40		2.0mm	
CODE	Length L mm	KG ad/pc	pcs
SEP Y40 20 HDG	1500	1.42	1

SEP H40 HDG

SEP Y40 HDG

APPLICATIONS
Cable routing

MATERIAL
HDG-steel, hot-dip galv. to TS-EN ISO 1461:2011 (HDG)

Available finishes:
Steel, strip-galv. acc. to the Sendzimir method to TS-EN 10346:2011 (PG)
SS- stainless steel AISI 304L and AISI 316L (SS)
EP- powder coating in a full range of colours (RAL)

Thickn. (ga) [mm]: **1.5 2.0**

Cable Trays - System of Side Height H40

Reducer Connection / Bend Reducer

Redüksiyon Eki / Dönüş reduksiyon (Tek) - Редукционный переходник лотков и углов

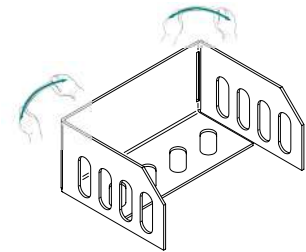
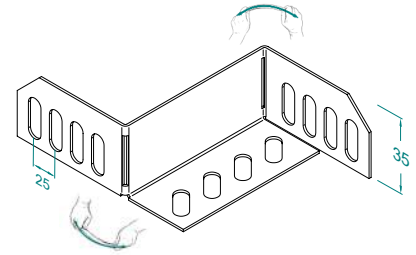
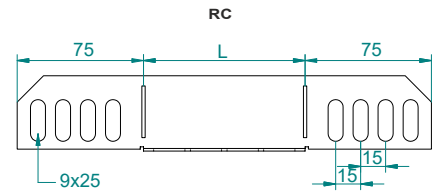
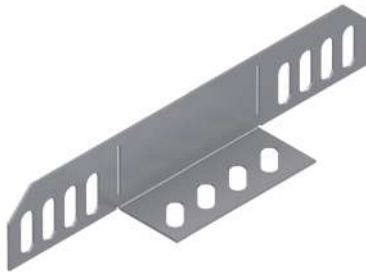

Hot-Dip Galvanized

RC ... H40		1.5mm	
CODE	Length L mm	KG ad/pc	pcs
RC 40 25 15 HDG	25	0.10	1
RC 40 50 15 HDG	50	0.12	1
RC 40 75 15 HDG	75	0.15	1
RC 40 100 15 HDG	100	0.17	1
RC 40 125 15 HDG	125	0.19	1
RC 40 150 15 HDG	150	0.22	1
RC 40 175 15 HDG	175	0.24	1
RC 40 200 15 HDG	200	0.26	1
RC 40 225 15 HDG	225	0.29	1
RC 40 250 15 HDG	250	0.31	1
RC 40 275 15 HDG	275	0.33	1
RC 40 300 15 HDG	300	0.36	1
RC 40 325 15 HDG	325	0.38	1
RC 40 350 15 HDG	350	0.41	1
RC 40 375 15 HDG	375	0.43	1
RC 40 400 15 HDG	400	0.45	1
RC 40 425 15 HDG	425	0.48	1
RC 40 450 15 HDG	450	0.50	1
RC 40 475 15 HDG	475	0.52	1
RC 40 500 15 HDG	500	0.55	1
RC 40 525 15 HDG	525	0.57	1
RC 40 550 15 HDG	550	0.59	1
RC 40 575 15 HDG	575	0.62	1

Important!

To install cable tray - bend use Screw Sets CFS M6 or CFS M8

RC ... H40		2.0mm	
CODE	Length L mm	KG ad/pc	pcs
RC 40 25 20 HDG	25	0.13	1
RC 40 50 20 HDG	50	0.16	1
RC 40 75 20 HDG	75	0.19	1
RC 40 100 20 HDG	100	0.22	1
RC 40 125 20 HDG	125	0.26	1
RC 40 150 20 HDG	150	0.29	1
RC 40 175 20 HDG	175	0.32	1
RC 40 200 20 HDG	200	0.35	1
RC 40 225 20 HDG	225	0.38	1
RC 40 250 20 HDG	250	0.41	1
RC 40 275 20 HDG	275	0.44	1
RC 40 300 20 HDG	300	0.48	1
RC 40 325 20 HDG	325	0.51	1
RC 40 350 20 HDG	350	0.54	1
RC 40 375 20 HDG	375	0.57	1
RC 40 400 20 HDG	400	0.60	1
RC 40 425 20 HDG	425	0.63	1
RC 40 450 20 HDG	450	0.66	1
RC 40 475 20 HDG	475	0.70	1
RC 40 500 20 HDG	500	0.73	1
RC 40 525 20 HDG	525	0.76	1
RC 40 550 20 HDG	550	0.79	1
RC 40 575 20 HDG	575	0.82	1

Expansion Plate

Birleştirme Elemanı - Соединитель на расстоянии

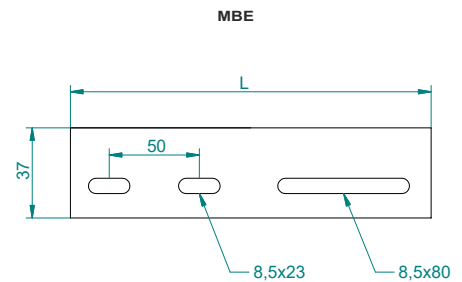
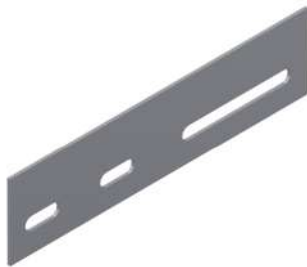

Hot-Dip Galvanized

MBE ... H40		1.5mm	
CODE	KG ad/pc	pcs	
MBE 40 15 HDG	0.08	1	

Important!

To install cable tray - bend use Screw Sets CFS M6 or CFS M8

MBE ... H40		2.0mm	
CODE	KG ad/pc	pcs	
MBE 40 20 HDG	0.11	1	

APPLICATIONS

Cable routing

MATERIAL

HDG-steel, hot-dip galv. to TS-EN ISO 1461:2011 (HDG)

Available finishes:

Steel, strip-galv. acc. to the Sendzimir method to TS-EN 10346:2011 (PG)
SS- stainless steel AISI 304L and AISI 316L (SS)
EP- powder coating in a full range of colours (RAL)

Thickn. (ga) [mm]: 1.5 2.0